

SHA Contract #5013

Rainier Vista Phase 1 Roof and Gutter Cleaning

Fax to 206 615-3410 Attn: Alan Hoffer

No later than 4:00 PM on the date shown in Request for Bids

Checklist: Include the following completed and signed forms:

- _____ Request for Bids Form
- _____ SHA Vendor Fact Sheet
- _____ Section 3 Business Certification Form
- _____ Section 3 Resident Employment Plan
- _____ Suspension & Debarment Contractor Compliance Certificate
- _____ Certification of Compliance with Wage Payment Statutes

CA: Alan Hoffer



Address 190 Queen Anne Ave N
PO Box 19028

Telephone 206-615-3300

TTY 1-800-833-6388

Website www.seattlehousing.org

Seattle Housing Authority (SHA) SWR Bid Opportunity, Solicitation # **5013**

As an approved contractor on the MRSC Small Public Works Roster, you are invited to bid on the following project:

SEATTLE HOUSING AUTHORITY (SHA) SOLICITATION # **5013**

Project Name: Rainier Vista Phase 1 Roof and Gutter Cleaning

BID DUE DATE AND TIME: August 25, 2017 @ 4:00 p.m.

PRE-BID CONFERENCE:

☒ There will be no pre-bid conference, and contractors are encouraged to visit the site independently.

BID DOCUMENTS ATTACHED:

Thank you for your interest,

Alan Hoffer
Contract Administrator Buyer II
Seattle Housing Authority
PO Box 19028
Seattle, WA 98109-1028

Phone: 206-615-3381
Fax: 206-615-3410
Al.Hoffer@seattlehousing.org



190 Queen Anne Ave N
PO Box 19028
Seattle, WA 98109-1028

REQUEST FOR BIDS (by Fax or email)

Date: 8-9-17		To: Potential Bidders for SHA Solicitation #5013	
The work described below is subject to the conditions described on Attachment A, version 1 <input type="checkbox"/> version 2 <input checked="" type="checkbox"/> version 3 <input type="checkbox"/>			
SHA Reference No.: 5013	(Federal Prevailing Wages) Federal Wage Decision No.:	OR	(State Prevailing Wages) Date of State Prevailing Wage Schedule: 8/25/2017
Number of Calendar Days to Complete Work: 3 months	For Questions Contact: Alan Hoffer	Phone No.: (206) 615-3381	
		FAX No.: (206) 615-3410	
		E-mail: Al.Hoffer@seattlehousing.org	
Project Description / Scope of Work: <input checked="" type="checkbox"/> See Scope of Work attached. <input type="checkbox"/> See Scope of Work below. Rainier Vista Phase I Roof and Gutter Cleaning – Section A, B & C			
BID DUE DATE AND TIME: <u>8/25/2017 / 4:00 p.m.</u> The bidder is responsible for ensuring that its Bid is received prior to the deadline. Bids received after the deadline will not be considered. FAX YOUR BID TO: <u>(206) 615-3410</u> or email to <u>Al.Hoffer@seattlehousing.org</u> or deliver to 190 Queen Anne Ave N, Seattle, WA 98109-1028, 5 th floor attn.: Alan Hoffer.			
BIDDER MUST COMPLETE THE INFORMATION BELOW. In addition, if bidder has never done business with SHA, it must submit a vendor fact sheet with its bid form. Bidder must also submit the required Section 3 forms with its bid form. <input checked="" type="checkbox"/> If checked, Bidder must complete the attached Detailed Bid Price Form and provide the total bid price below.			
Basic Bid Price (without Sales Tax)	Sales Tax (see Attachment A)	Total Bid Price (with Sales Tax)	
Bidder's Business Name:	Telephone No.:	E-Mail Address:	
Address:		City, State, Zip Code:	
Business Classification: <input type="checkbox"/> WBE <input type="checkbox"/> MBE <input type="checkbox"/> MWBE <input type="checkbox"/> Section 3		Contractor Registration No.:	
Signature:	Date:	Printed Name and Title of Person Signing Bid:	
By signing above, the Bidder acknowledges receipt of Attachment A and any addenda issued for this project, and proposes to furnish all material and labor and to perform all work described herein for the Bid Price noted above. The Bidder also certifies the following:: to have personally and carefully evaluated the Project Description / Scope of Work and Attachment A, and to have a clear understanding of the same, including the requirement to pay prevailing wages.			

SHADED AREA FOR USE BY SHA ONLY: Use this form only for projects estimated to cost less than \$100,000

Required Number of Bids to Solicit for a job less than \$10,000:

Federally Funded: 1 bid

Non-Federally Funded: 1 bid

Required Number of Bids to Solicit for a job less than \$100,000:

Federally Funded 3 bids

Non-Federally Funded 5 bids

See Purchasing policies for solicitation of jobs \$100,000 and above.

For Federally and Non-Federally Funded jobs, **all** bidders **must** be on the Municipal Research Services Center 's (MRSC) small works roster at www.mrscrosters.org **prior** to soliciting bids.

Bidder's Name:

INDIVIDUAL PRICES: Bidders shall fill out the individual monthly maintenance prices listed below, however, a lump sum total shall be listed on the Bid Form. Do not include tax in the monthly maintenance fees as this amount will be added to the total on the Bid Form.

Service Items	Basic Bid Price (no sales tax)	Materials Price	Sales Tax	Total Bid Price (with sales tax)
Item One Chemically treat the moss and algae, then return to brush away dead moss and algae.	<input type="text"/>	<input type="text"/>	<input type="text"/>	<input type="text"/>
Item Two Apply enviornmentaly safe treatment to retard moss and algae growth.	<input type="text"/>	<input type="text"/>	<input type="text"/>	<input type="text"/>
Item Three Flush and clean entire gutter system, including downspouts.	<input type="text"/>	<input type="text"/>	<input type="text"/>	<input type="text"/>
Item Four Clean up all job debris from job site - rinse down or blow off all debris	<input type="text"/>	<input type="text"/>	<input type="text"/>	<input type="text"/>
Item Five (additional services as needed) Gutter system repairs	<input type="text"/>	<input type="text"/>	<input type="text"/>	<input type="text"/>

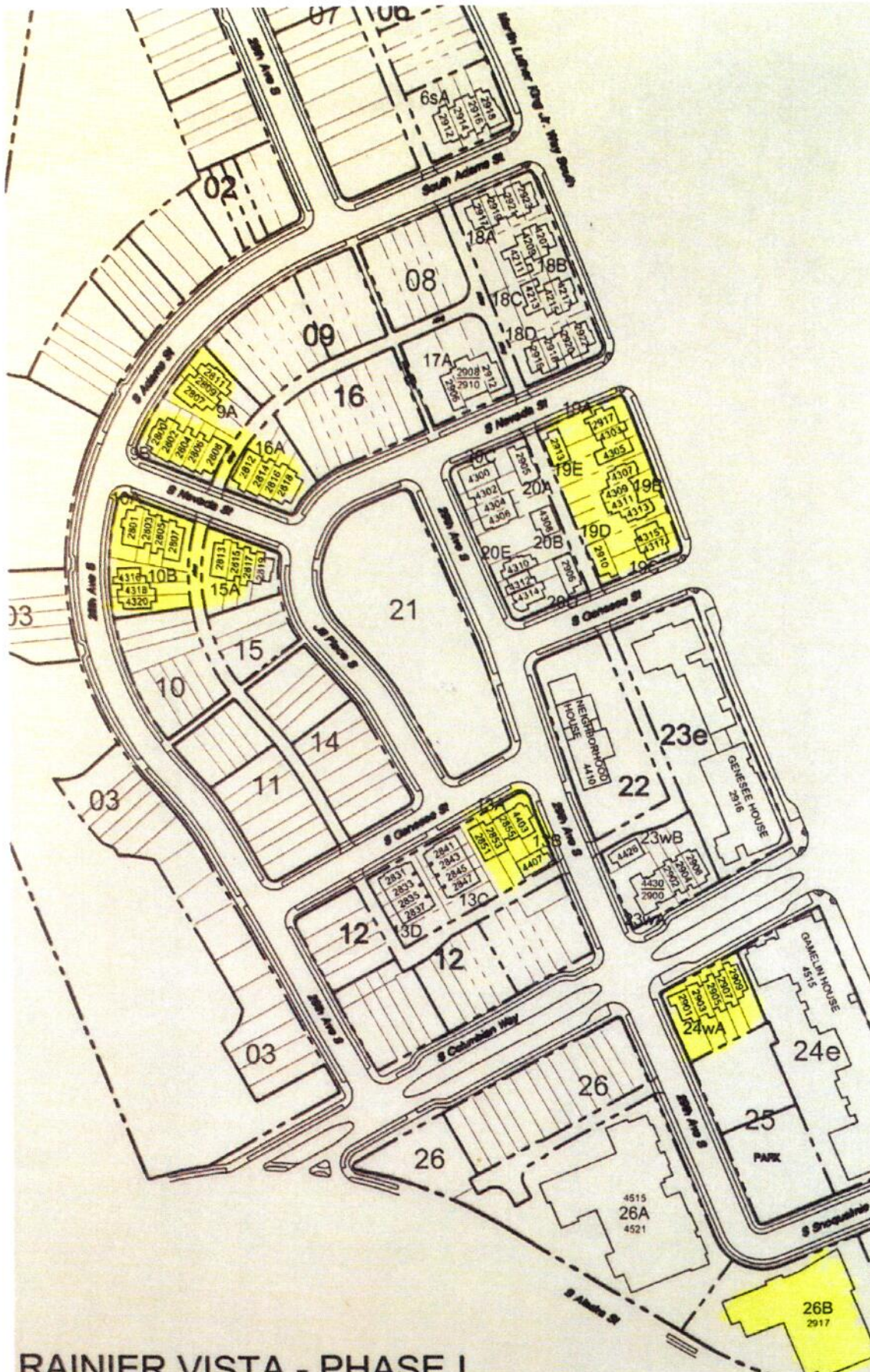

RAINIER VISTA - PHASE I

2800 S. Nevada St.
 2802 S. Nevada St.
 2804 S. Nevada St.
 2806 S. Nevada St.
 2808 S. Nevada St.
 2812 S. Nevada St.
 2814 S. Nevada St.
 2816 S. Nevada St.
 2818 S. Nevada St.
 2807 S. Adams St.
 2809 S. Adams St.
 2811 S. Adams St.
 2801 S. Nevada St.
 2803 S. Nevada St.
 2805 S. Nevada St.
 2807 S. Nevada St.
 2813 S. Nevada St.
 2815 S. Nevada St.
 2817 S. Nevada St.
 2819 S. Nevada St.
 4316 28th Ave S
 4318 28th Ave S
 4320 28th Ave S

4403 29th Ave S.
 4407 29th Ave S.
 2851 S. Genesee St.
 2853 S. Genesee St.
 2855 S. Genesee St.

2909 S. Columbian Way
 2907 S. Columbian Way
 2905 S. Columbian Way
 2903 S. Columbian Way
 2901 S. Columbian Way

2917 S. Nevada St.
 4303 MLK Jr Way S
 4305 MLK Jr Way S
 4307 MLK Jr Way S
 4309 MLK Jr Way S
 4311 MLK Jr Way S
 4313 MLK Jr Way S
 4315 MLK Jr Way S
 4317 MLK Jr Way S

Snoqualmie Building: 2917 S. Snoc

Solicitation 5013

Scope of Work

**Rainier Vista Phase I Roof and Gutter Cleaning
#5013**

General Requirements:

- a. Provide all labor, material, supplies and equipment necessary to provide gutter services described in these specification.
- b. All work shall be done in accordance with DOSH (Department of Safety and Health) practices. This includes but not limited to WAC 296-876 (Ladders, Portable and Fixed), WAC 296-807 (Portable Power Tools), WAC 296-155 (Fall Protection, Fall Restraint and Fall Arrest), WAC 296-800 (Personal Protective Equipment), WAC 296-869 (Elevating Work Platforms).
- c. At the beginning of the Contract, the Contractor shall submit a proposed schedule to accomplish the work indicated.
- d. All work shall be accomplished on a regularly scheduled basis during normal working hours (6:00 a.m. to 7:00 p.m., Monday through Friday, except holidays).
- e. Contractor shall provide the name of their contact person who can be reached by phone during the hours of 7:30 a.m. through 5:00 p.m., Monday through Friday. This person shall have the authority to give supervisory instruction to the crew assigned to this Contract.
- f. Contractor shall also provide a contract phone number for 24-hour, 7-day emergency service, with a maximum response time of 12 hours.
- g. Contractor performance will be reviewed periodically for compliance with the terms of the Contract.

Scope:

One-time service for the addresses specified on the attached map of Rainier Vista.

1. Chemically treat moss and algae on roof. Then return to brush away dead moss and algae.
2. Apply environmentally safe treatment to retard moss and algae growth.
3. Flush and clean entire gutter system, including downspouts.
4. Clean up all job debris from job site – rinse down or blow off all debris.

Additional Services to be Provided as Needed

The following services are available for bid or time and materials upon the approval of Management:

- a. Gutter system repairs.

State of Washington
Department of Labor & Industries
Prevailing Wage Section - Telephone 360-902-5335
PO Box 44540, Olympia, WA 98504-4540

Washington State Prevailing Wage

The PREVAILING WAGES listed here include both the hourly wage rate and the hourly rate of fringe benefits. On public works projects, worker's wage and benefit rates must add to not less than this total. A brief description of overtime calculation requirements are provided on the Benefit Code Key.

Journey Level Prevailing Wage Rates for the Effective Date: 08/25/2017

County	Trade	Job Classification	Wage	Holiday	Overtime	Note
King	Asbestos Abatement Workers	Journey Level	\$45.25	5D	1H	
King	Boilermakers	Journey Level	\$64.54	5N	1C	
King	Brick Mason	Journey Level	\$54.32	5A	1M	
King	Brick Mason	Pointer-Caulker-Cleaner	\$54.32	5A	1M	
King	Building Service Employees	Janitor	\$22.84	5S	2F	
King	Building Service Employees	Traveling Waxer/Shampooer	\$23.29	5S	2F	
King	Building Service Employees	Window Cleaner (Non-Scaffold)	\$24.54	5S	2F	
King	Building Service Employees	Window Cleaner (Scaffold)	\$27.33	5S	2F	
King	Cabinet Makers (In Shop)	Journey Level	\$22.74		1	
King	Carpenters	Acoustical Worker	\$55.51	5D	4C	
King	Carpenters	Bridge, Dock And Wharf Carpenters	\$55.51	5D	4C	
King	Carpenters	Carpenter	\$55.51	5D	4C	
King	Carpenters	Carpenters on Stationary Tools	\$55.64	5D	4C	
King	Carpenters	Creosoted Material	\$55.61	5D	4C	
King	Carpenters	Floor Finisher	\$55.51	5D	4C	
King	Carpenters	Floor Layer	\$55.51	5D	4C	
King	Carpenters	Scaffold Erector	\$55.51	5D	4C	
King	Cement Masons	Journey Level	\$55.56	7A	1M	
King	Divers & Tenders	Diver	\$108.77	5D	4C	8A
King	Divers & Tenders	Diver On Standby	\$66.05	5D	4C	
King	Divers & Tenders	Diver Tender	\$59.88	5D	4C	
King	Divers & Tenders	Surface Rcv & Rov Operator	\$59.88	5D	4C	
King	Divers & Tenders	Surface Rcv & Rov Operator Tender	\$55.76	5A	4C	
King	Dredge Workers	Assistant Engineer	\$56.44	5D	3F	
King	Dredge Workers	Assistant Mate (Deckhand)	\$56.00	5D	3F	
King	Dredge Workers	Boatmen	\$56.44	5D	3F	
King	Dredge Workers	Engineer Welder	\$57.51	5D	3F	
King	Dredge Workers	Leverman, Hydraulic	\$58.67	5D	3F	

King	<u>Dredge Workers</u>	Mates	\$56.44	<u>5D</u>	<u>3F</u>	
King	<u>Dredge Workers</u>	Oiler	\$56.00	<u>5D</u>	<u>3F</u>	
King	<u>Drywall Applicator</u>	Journey Level	\$55.51	<u>5D</u>	<u>1H</u>	
King	<u>Drywall Tapers</u>	Journey Level	\$55.66	<u>5P</u>	<u>1E</u>	
King	<u>Electrical Fixture Maintenance Workers</u>	Journey Level	\$27.99	<u>5L</u>	<u>1E</u>	
King	<u>Electricians - Inside</u>	Cable Splicer	\$73.20	<u>7C</u>	<u>4E</u>	
King	<u>Electricians - Inside</u>	Cable Splicer (tunnel)	\$78.59	<u>7C</u>	<u>4E</u>	
King	<u>Electricians - Inside</u>	Certified Welder	\$70.75	<u>7C</u>	<u>4E</u>	
King	<u>Electricians - Inside</u>	Certified Welder (tunnel)	\$75.89	<u>7C</u>	<u>4E</u>	
King	<u>Electricians - Inside</u>	Construction Stock Person	\$38.69	<u>7C</u>	<u>4E</u>	
King	<u>Electricians - Inside</u>	Journey Level	\$68.30	<u>7C</u>	<u>4E</u>	
King	<u>Electricians - Inside</u>	Journey Level (tunnel)	\$73.20	<u>7C</u>	<u>4E</u>	
King	<u>Electricians - Motor Shop</u>	Craftsman	\$15.37		<u>1</u>	
King	<u>Electricians - Motor Shop</u>	Journey Level	\$14.69		<u>1</u>	
King	<u>Electricians - Powerline Construction</u>	Cable Splicer	\$73.93	<u>5A</u>	<u>4D</u>	
King	<u>Electricians - Powerline Construction</u>	Certified Line Welder	\$67.60	<u>5A</u>	<u>4D</u>	
King	<u>Electricians - Powerline Construction</u>	Groundperson	\$45.49	<u>5A</u>	<u>4D</u>	
King	<u>Electricians - Powerline Construction</u>	Heavy Line Equipment Operator	\$67.60	<u>5A</u>	<u>4D</u>	
King	<u>Electricians - Powerline Construction</u>	Journey Level Lineperson	\$67.60	<u>5A</u>	<u>4D</u>	
King	<u>Electricians - Powerline Construction</u>	Line Equipment Operator	\$57.02	<u>5A</u>	<u>4D</u>	
King	<u>Electricians - Powerline Construction</u>	Pole Sprayer	\$67.60	<u>5A</u>	<u>4D</u>	
King	<u>Electricians - Powerline Construction</u>	Powderperson	\$50.76	<u>5A</u>	<u>4D</u>	
King	<u>Electronic Technicians</u>	Journey Level	\$31.00		<u>1</u>	
King	<u>Elevator Constructors</u>	Mechanic	\$85.45	<u>7D</u>	<u>4A</u>	
King	<u>Elevator Constructors</u>	Mechanic In Charge	\$92.35	<u>7D</u>	<u>4A</u>	
King	<u>Fabricated Precast Concrete Products</u>	All Classifications - In-Factory Work Only	\$17.20	<u>5B</u>	<u>1R</u>	
King	<u>Fence Erectors</u>	Fence Erector	\$15.18		<u>1</u>	
King	<u>Flaggers</u>	Journey Level	\$38.36	<u>7A</u>	<u>3I</u>	
King	<u>Glaziers</u>	Journey Level	\$59.31	<u>7L</u>	<u>1Y</u>	
King	<u>Heat & Frost Insulators And Asbestos Workers</u>	Journeyman	\$65.68	<u>5J</u>	<u>4H</u>	
King	<u>Heating Equipment Mechanics</u>	Journey Level	\$75.46	<u>7F</u>	<u>1E</u>	
King	<u>Hod Carriers & Mason Tenders</u>	Journey Level	\$46.66	<u>7A</u>	<u>3I</u>	
King	<u>Industrial Power Vacuum Cleaner</u>	Journey Level	\$11.00		<u>1</u>	
King	<u>Inland Boatmen</u>	Boat Operator	\$59.86	<u>5B</u>	<u>1K</u>	
King	<u>Inland Boatmen</u>	Cook	\$56.18	<u>5B</u>	<u>1K</u>	
King	<u>Inland Boatmen</u>	Deckhand	\$56.18	<u>5B</u>	<u>1K</u>	

King	<u>Inland Boatmen</u>	Deckhand Engineer	\$57.26	<u>5B</u>	<u>1K</u>	
King	<u>Inland Boatmen</u>	Launch Operator	\$58.59	<u>5B</u>	<u>1K</u>	
King	<u>Inland Boatmen</u>	Mate	\$58.59	<u>5B</u>	<u>1K</u>	
King	<u>Inspection/Cleaning/Sealing Of Sewer & Water Systems By Remote Control</u>	Cleaner Operator, Foamer Operator	\$31.49		<u>1</u>	
King	<u>Inspection/Cleaning/Sealing Of Sewer & Water Systems By Remote Control</u>	Grout Truck Operator	\$11.48		<u>1</u>	
King	<u>Inspection/Cleaning/Sealing Of Sewer & Water Systems By Remote Control</u>	Head Operator	\$24.91		<u>1</u>	
King	<u>Inspection/Cleaning/Sealing Of Sewer & Water Systems By Remote Control</u>	Technician	\$19.33		<u>1</u>	
King	<u>Inspection/Cleaning/Sealing Of Sewer & Water Systems By Remote Control</u>	Tv Truck Operator	\$20.45		<u>1</u>	
King	<u>Insulation Applicators</u>	Journey Level	\$55.51	<u>5D</u>	<u>4C</u>	
King	<u>Ironworkers</u>	Journeyman	\$65.48	<u>7N</u>	<u>1O</u>	
King	<u>Laborers</u>	Air, Gas Or Electric Vibrating Screed	\$45.25	<u>7A</u>	<u>3I</u>	
King	<u>Laborers</u>	Airtrac Drill Operator	\$46.66	<u>7A</u>	<u>3I</u>	
King	<u>Laborers</u>	Ballast Regular Machine	\$45.25	<u>7A</u>	<u>3I</u>	
King	<u>Laborers</u>	Batch Weighman	\$38.36	<u>7A</u>	<u>3I</u>	
King	<u>Laborers</u>	Brick Pavers	\$45.25	<u>7A</u>	<u>3I</u>	
King	<u>Laborers</u>	Brush Cutter	\$45.25	<u>7A</u>	<u>3I</u>	
King	<u>Laborers</u>	Brush Hog Feeder	\$45.25	<u>7A</u>	<u>3I</u>	
King	<u>Laborers</u>	Burner	\$45.25	<u>7A</u>	<u>3I</u>	
King	<u>Laborers</u>	Caisson Worker	\$46.66	<u>7A</u>	<u>3I</u>	
King	<u>Laborers</u>	Carpenter Tender	\$45.25	<u>7A</u>	<u>3I</u>	
King	<u>Laborers</u>	Caulker	\$45.25	<u>7A</u>	<u>3I</u>	
King	<u>Laborers</u>	Cement Dumper-paving	\$46.09	<u>7A</u>	<u>3I</u>	
King	<u>Laborers</u>	Cement Finisher Tender	\$45.25	<u>7A</u>	<u>3I</u>	
King	<u>Laborers</u>	Change House Or Dry Shack	\$45.25	<u>7A</u>	<u>3I</u>	
King	<u>Laborers</u>	Chipping Gun (under 30 Lbs.)	\$45.25	<u>7A</u>	<u>3I</u>	
King	<u>Laborers</u>	Chipping Gun(30 Lbs. And Over)	\$46.09	<u>7A</u>	<u>3I</u>	
King	<u>Laborers</u>	Choker Setter	\$45.25	<u>7A</u>	<u>3I</u>	
King	<u>Laborers</u>	Chuck Tender	\$45.25	<u>7A</u>	<u>3I</u>	
King	<u>Laborers</u>	Clary Power Spreader	\$46.09	<u>7A</u>	<u>3I</u>	
King	<u>Laborers</u>	Clean-up Laborer	\$45.25	<u>7A</u>	<u>3I</u>	
King	<u>Laborers</u>	Concrete Dumper/chute Operator	\$46.09	<u>7A</u>	<u>3I</u>	
King	<u>Laborers</u>	Concrete Form Stripper	\$45.25	<u>7A</u>	<u>3I</u>	
King	<u>Laborers</u>	Concrete Placement Crew	\$46.09	<u>7A</u>	<u>3I</u>	
King	<u>Laborers</u>	Concrete Saw Operator/core Driller	\$46.09	<u>7A</u>	<u>3I</u>	

King	<u>Laborers</u>	Crusher Feeder	\$38.36	<u>7A</u>	<u>3I</u>	
King	<u>Laborers</u>	Curing Laborer	\$45.25	<u>7A</u>	<u>3I</u>	
King	<u>Laborers</u>	Demolition: Wrecking & Moving (incl. Charred Material)	\$45.25	<u>7A</u>	<u>3I</u>	
King	<u>Laborers</u>	Ditch Digger	\$45.25	<u>7A</u>	<u>3I</u>	
King	<u>Laborers</u>	Diver	\$46.66	<u>7A</u>	<u>3I</u>	
King	<u>Laborers</u>	Drill Operator (hydraulic, diamond)	\$46.09	<u>7A</u>	<u>3I</u>	
King	<u>Laborers</u>	Dry Stack Walls	\$45.25	<u>7A</u>	<u>3I</u>	
King	<u>Laborers</u>	Dump Person	\$45.25	<u>7A</u>	<u>3I</u>	
King	<u>Laborers</u>	Epoxy Technician	\$45.25	<u>7A</u>	<u>3I</u>	
King	<u>Laborers</u>	Erosion Control Worker	\$45.25	<u>7A</u>	<u>3I</u>	
King	<u>Laborers</u>	Faller & Bucker Chain Saw	\$46.09	<u>7A</u>	<u>3I</u>	
King	<u>Laborers</u>	Fine Graders	\$45.25	<u>7A</u>	<u>3I</u>	
King	<u>Laborers</u>	Firewatch	\$38.36	<u>7A</u>	<u>3I</u>	
King	<u>Laborers</u>	Form Setter	\$45.25	<u>7A</u>	<u>3I</u>	
King	<u>Laborers</u>	Gabian Basket Builders	\$45.25	<u>7A</u>	<u>3I</u>	
King	<u>Laborers</u>	General Laborer	\$45.25	<u>7A</u>	<u>3I</u>	
King	<u>Laborers</u>	Grade Checker & Transit Person	\$46.66	<u>7A</u>	<u>3I</u>	
King	<u>Laborers</u>	Grinders	\$45.25	<u>7A</u>	<u>3I</u>	
King	<u>Laborers</u>	Grout Machine Tender	\$45.25	<u>7A</u>	<u>3I</u>	
King	<u>Laborers</u>	Groutmen (pressure)including Post Tension Beams	\$46.09	<u>7A</u>	<u>3I</u>	
King	<u>Laborers</u>	Guardrail Erector	\$45.25	<u>7A</u>	<u>3I</u>	
King	<u>Laborers</u>	Hazardous Waste Worker (level A)	\$46.66	<u>7A</u>	<u>3I</u>	
King	<u>Laborers</u>	Hazardous Waste Worker (level B)	\$46.09	<u>7A</u>	<u>3I</u>	
King	<u>Laborers</u>	Hazardous Waste Worker (level C)	\$45.25	<u>7A</u>	<u>3I</u>	
King	<u>Laborers</u>	High Scaler	\$46.66	<u>7A</u>	<u>3I</u>	
King	<u>Laborers</u>	Jackhammer	\$46.09	<u>7A</u>	<u>3I</u>	
King	<u>Laborers</u>	Laserbeam Operator	\$46.09	<u>7A</u>	<u>3I</u>	
King	<u>Laborers</u>	Maintenance Person	\$45.25	<u>7A</u>	<u>3I</u>	
King	<u>Laborers</u>	Manhole Builder-mudman	\$46.09	<u>7A</u>	<u>3I</u>	
King	<u>Laborers</u>	Material Yard Person	\$45.25	<u>7A</u>	<u>3I</u>	
King	<u>Laborers</u>	Motorman-dinky Locomotive	\$46.09	<u>7A</u>	<u>3I</u>	
King	<u>Laborers</u>	Nozzleman (concrete Pump, Green Cutter When Using Combination Of High Pressure Air & Water On Concrete & Rock, Sandblast, Gunite, Shotcrete, Water Bla	\$46.09	<u>7A</u>	<u>3I</u>	
King	<u>Laborers</u>	Pavement Breaker	\$46.09	<u>7A</u>	<u>3I</u>	
King	<u>Laborers</u>	Pilot Car	\$38.36	<u>7A</u>	<u>3I</u>	
King	<u>Laborers</u>	Pipe Layer Lead	\$46.66	<u>7A</u>	<u>3I</u>	

King	<u>Laborers</u>	Pipe Layer/tailor	\$46.09	<u>7A</u>	<u>3I</u>	
King	<u>Laborers</u>	Pipe Pot Tender	\$46.09	<u>7A</u>	<u>3I</u>	
King	<u>Laborers</u>	Pipe Reliner	\$46.09	<u>7A</u>	<u>3I</u>	
King	<u>Laborers</u>	Pipe Wrapper	\$46.09	<u>7A</u>	<u>3I</u>	
King	<u>Laborers</u>	Pot Tender	\$45.25	<u>7A</u>	<u>3I</u>	
King	<u>Laborers</u>	Powderman	\$46.66	<u>7A</u>	<u>3I</u>	
King	<u>Laborers</u>	Powderman's Helper	\$45.25	<u>7A</u>	<u>3I</u>	
King	<u>Laborers</u>	Power Jacks	\$46.09	<u>7A</u>	<u>3I</u>	
King	<u>Laborers</u>	Railroad Spike Puller - Power	\$46.09	<u>7A</u>	<u>3I</u>	
King	<u>Laborers</u>	Raker - Asphalt	\$46.66	<u>7A</u>	<u>3I</u>	
King	<u>Laborers</u>	Re-timberman	\$46.66	<u>7A</u>	<u>3I</u>	
King	<u>Laborers</u>	Remote Equipment Operator	\$46.09	<u>7A</u>	<u>3I</u>	
King	<u>Laborers</u>	Rigger/signal Person	\$46.09	<u>7A</u>	<u>3I</u>	
King	<u>Laborers</u>	Rip Rap Person	\$45.25	<u>7A</u>	<u>3I</u>	
King	<u>Laborers</u>	Rivet Buster	\$46.09	<u>7A</u>	<u>3I</u>	
King	<u>Laborers</u>	Rodder	\$46.09	<u>7A</u>	<u>3I</u>	
King	<u>Laborers</u>	Scaffold Erector	\$45.25	<u>7A</u>	<u>3I</u>	
King	<u>Laborers</u>	Scale Person	\$45.25	<u>7A</u>	<u>3I</u>	
King	<u>Laborers</u>	Sloper (over 20")	\$46.09	<u>7A</u>	<u>3I</u>	
King	<u>Laborers</u>	Sloper Sprayer	\$45.25	<u>7A</u>	<u>3I</u>	
King	<u>Laborers</u>	Spreader (concrete)	\$46.09	<u>7A</u>	<u>3I</u>	
King	<u>Laborers</u>	Stake Hopper	\$45.25	<u>7A</u>	<u>3I</u>	
King	<u>Laborers</u>	Stock Piler	\$45.25	<u>7A</u>	<u>3I</u>	
King	<u>Laborers</u>	Tamper & Similar Electric, Air & Gas Operated Tools	\$46.09	<u>7A</u>	<u>3I</u>	
King	<u>Laborers</u>	Tamper (multiple & Self-propelled)	\$46.09	<u>7A</u>	<u>3I</u>	
King	<u>Laborers</u>	Timber Person - Sewer (lagger, Shorer & Cribber)	\$46.09	<u>7A</u>	<u>3I</u>	
King	<u>Laborers</u>	Toolroom Person (at Jobsite)	\$45.25	<u>7A</u>	<u>3I</u>	
King	<u>Laborers</u>	Topper	\$45.25	<u>7A</u>	<u>3I</u>	
King	<u>Laborers</u>	Track Laborer	\$45.25	<u>7A</u>	<u>3I</u>	
King	<u>Laborers</u>	Track Liner (power)	\$46.09	<u>7A</u>	<u>3I</u>	
King	<u>Laborers</u>	Traffic Control Laborer	\$41.02	<u>7A</u>	<u>3I</u>	<u>8R</u>
King	<u>Laborers</u>	Traffic Control Supervisor	\$41.02	<u>7A</u>	<u>3I</u>	<u>8R</u>
King	<u>Laborers</u>	Truck Spotter	\$45.25	<u>7A</u>	<u>3I</u>	
King	<u>Laborers</u>	Tugger Operator	\$46.09	<u>7A</u>	<u>3I</u>	
King	<u>Laborers</u>	Tunnel Work-Compressed Air Worker 0-30 psi	\$83.12	<u>7A</u>	<u>3I</u>	<u>8Q</u>
King	<u>Laborers</u>	Tunnel Work-Compressed Air Worker 30.01-44.00 psi	\$88.15	<u>7A</u>	<u>3I</u>	<u>8Q</u>
King	<u>Laborers</u>	Tunnel Work-Compressed Air Worker 44.01-54.00 psi	\$91.83	<u>7A</u>	<u>3I</u>	<u>8Q</u>
King	<u>Laborers</u>	Tunnel Work-Compressed Air Worker 54.01-60.00 psi	\$97.53	<u>7A</u>	<u>3I</u>	<u>8Q</u>
King	<u>Laborers</u>	Tunnel Work-Compressed Air Worker 60.01-64.00 psi	\$99.65	<u>7A</u>	<u>3I</u>	<u>8Q</u>

King	<u>Laborers</u>	Tunnel Work-Compressed Air Worker 64.01-68.00 psi	\$104.75	<u>7A</u>	<u>3I</u>	<u>8Q</u>
King	<u>Laborers</u>	Tunnel Work-Compressed Air Worker 68.01-70.00 psi	\$106.65	<u>7A</u>	<u>3I</u>	<u>8Q</u>
King	<u>Laborers</u>	Tunnel Work-Compressed Air Worker 70.01-72.00 psi	\$108.65	<u>7A</u>	<u>3I</u>	<u>8Q</u>
King	<u>Laborers</u>	Tunnel Work-Compressed Air Worker 72.01-74.00 psi	\$110.65	<u>7A</u>	<u>3I</u>	<u>8Q</u>
King	<u>Laborers</u>	Tunnel Work-Guage and Lock Tender	\$46.76	<u>7A</u>	<u>3I</u>	<u>8Q</u>
King	<u>Laborers</u>	Tunnel Work-Miner	\$46.76	<u>7A</u>	<u>3I</u>	<u>8Q</u>
King	<u>Laborers</u>	Vibrator	\$46.09	<u>7A</u>	<u>3I</u>	
King	<u>Laborers</u>	Vinyl Seamer	\$45.25	<u>7A</u>	<u>3I</u>	
King	<u>Laborers</u>	Watchman	\$34.86	<u>7A</u>	<u>3I</u>	
King	<u>Laborers</u>	Welder	\$46.09	<u>7A</u>	<u>3I</u>	
King	<u>Laborers</u>	Well Point Laborer	\$46.09	<u>7A</u>	<u>3I</u>	
King	<u>Laborers</u>	Window Washer/cleaner	\$34.86	<u>7A</u>	<u>3I</u>	
King	<u>Laborers - Underground Sewer & Water</u>	General Laborer & Topman	\$45.25	<u>7A</u>	<u>3I</u>	
King	<u>Laborers - Underground Sewer & Water</u>	Pipe Layer	\$46.09	<u>7A</u>	<u>3I</u>	
King	<u>Landscape Construction</u>	Irrigation Or Lawn Sprinkler Installers	\$13.56		<u>1</u>	
King	<u>Landscape Construction</u>	Landscape Equipment Operators Or Truck Drivers	\$28.17		<u>1</u>	
King	<u>Landscape Construction</u>	Landscaping or Planting Laborers	\$17.87		<u>1</u>	
King	<u>Lathers</u>	Journey Level	\$55.51	<u>5D</u>	<u>1H</u>	
King	<u>Marble Setters</u>	Journey Level	\$54.32	<u>5A</u>	<u>1M</u>	
King	<u>Metal Fabrication (In Shop)</u>	Fitter	\$15.86		<u>1</u>	
King	<u>Metal Fabrication (In Shop)</u>	Laborer	\$11.00		<u>1</u>	
King	<u>Metal Fabrication (In Shop)</u>	Machine Operator	\$13.04		<u>1</u>	
King	<u>Metal Fabrication (In Shop)</u>	Painter	\$11.10		<u>1</u>	
King	<u>Metal Fabrication (In Shop)</u>	Welder	\$15.48		<u>1</u>	
King	<u>Millwright</u>	Journey Level	\$57.01	<u>5D</u>	<u>4C</u>	
King	<u>Modular Buildings</u>	Cabinet Assembly	\$11.56		<u>1</u>	
King	<u>Modular Buildings</u>	Electrician	\$11.56		<u>1</u>	
King	<u>Modular Buildings</u>	Equipment Maintenance	\$11.56		<u>1</u>	
King	<u>Modular Buildings</u>	Plumber	\$11.56		<u>1</u>	
King	<u>Modular Buildings</u>	Production Worker	\$11.00		<u>1</u>	
King	<u>Modular Buildings</u>	Tool Maintenance	\$11.56		<u>1</u>	
King	<u>Modular Buildings</u>	Utility Person	\$11.56		<u>1</u>	
King	<u>Modular Buildings</u>	Welder	\$11.56		<u>1</u>	
King	<u>Painters</u>	Journey Level	\$40.60	<u>6Z</u>	<u>2B</u>	
King	<u>Pile Driver</u>	Journey Level	\$55.76	<u>5D</u>	<u>4C</u>	
King	<u>Plasterers</u>	Journey Level	\$53.20	<u>7Q</u>	<u>1R</u>	
King	<u>Playground & Park Equipment Installers</u>	Journey Level	\$11.00		<u>1</u>	

King	Plumbers & Pipefitters	Journey Level	\$76.69	<u>6Z</u>	<u>1G</u>	
King	Power Equipment Operators	Asphalt Plant Operators	\$58.69	<u>7A</u>	<u>3C</u>	<u>8P</u>
King	Power Equipment Operators	Assistant Engineer	\$55.21	<u>7A</u>	<u>3C</u>	<u>8P</u>
King	Power Equipment Operators	Barrier Machine (zipper)	\$58.17	<u>7A</u>	<u>3C</u>	<u>8P</u>
King	Power Equipment Operators	Batch Plant Operator, Concrete	\$58.17	<u>7A</u>	<u>3C</u>	<u>8P</u>
King	Power Equipment Operators	Bobcat	\$55.21	<u>7A</u>	<u>3C</u>	<u>8P</u>
King	Power Equipment Operators	Brokk - Remote Demolition Equipment	\$55.21	<u>7A</u>	<u>3C</u>	<u>8P</u>
King	Power Equipment Operators	Brooms	\$55.21	<u>7A</u>	<u>3C</u>	<u>8P</u>
King	Power Equipment Operators	Bump Cutter	\$58.17	<u>7A</u>	<u>3C</u>	<u>8P</u>
King	Power Equipment Operators	Cableways	\$58.69	<u>7A</u>	<u>3C</u>	<u>8P</u>
King	Power Equipment Operators	Chipper	\$58.17	<u>7A</u>	<u>3C</u>	<u>8P</u>
King	Power Equipment Operators	Compressor	\$55.21	<u>7A</u>	<u>3C</u>	<u>8P</u>
King	Power Equipment Operators	Concrete Pump: Truck Mount With Boom Attachment Over 42 M	\$58.69	<u>7A</u>	<u>3C</u>	<u>8P</u>
King	Power Equipment Operators	Concrete Finish Machine -laser Screed	\$55.21	<u>7A</u>	<u>3C</u>	<u>8P</u>
King	Power Equipment Operators	Concrete Pump - Mounted Or Trailer High Pressure Line Pump, Pump High Pressure.	\$57.72	<u>7A</u>	<u>3C</u>	<u>8P</u>
King	Power Equipment Operators	Concrete Pump: Truck Mount With Boom Attachment Up To 42m	\$58.17	<u>7A</u>	<u>3C</u>	<u>8P</u>
King	Power Equipment Operators	Conveyors	\$57.72	<u>7A</u>	<u>3C</u>	<u>8P</u>
King	Power Equipment Operators	Cranes Friction: 200 tons and over	\$60.47	<u>7A</u>	<u>3C</u>	<u>8P</u>
King	Power Equipment Operators	Cranes: 20 Tons Through 44 Tons With Attachments	\$58.17	<u>7A</u>	<u>3C</u>	<u>8P</u>
King	Power Equipment Operators	Cranes: 100 Tons Through 199 Tons, Or 150' Of Boom (Including Jib With Attachments)	\$59.28	<u>7A</u>	<u>3C</u>	<u>8P</u>
King	Power Equipment Operators	Cranes: 200 tons- 299 tons, or 250' of boom including jib with attachments	\$59.88	<u>7A</u>	<u>3C</u>	<u>8P</u>
King	Power Equipment Operators	Cranes: 300 tons and over or 300' of boom including jib with attachments	\$60.47	<u>7A</u>	<u>3C</u>	<u>8P</u>
King	Power Equipment Operators	Cranes: 45 Tons Through 99 Tons, Under 150' Of Boom (including Jib With Attachments)	\$58.69	<u>7A</u>	<u>3C</u>	<u>8P</u>
King	Power Equipment Operators	Cranes: A-frame - 10 Tons And Under	\$55.21	<u>7A</u>	<u>3C</u>	<u>8P</u>
King	Power Equipment Operators	Cranes: Friction cranes through 199 tons	\$59.88	<u>7A</u>	<u>3C</u>	<u>8P</u>
King	Power Equipment Operators	Cranes: Through 19 Tons With Attachments A-frame Over 10 Tons	\$57.72	<u>7A</u>	<u>3C</u>	<u>8P</u>

King	<u>Power Equipment Operators</u>	Crusher	\$58.17	<u>7A</u>	<u>3C</u>	<u>8P</u>
King	<u>Power Equipment Operators</u>	Deck Engineer /deck Winches (power)	\$58.17	<u>7A</u>	<u>3C</u>	<u>8P</u>
King	<u>Power Equipment Operators</u>	Derricks, On Building Work	\$58.69	<u>7A</u>	<u>3C</u>	<u>8P</u>
King	<u>Power Equipment Operators</u>	Dozers D-9 & Under	\$57.72	<u>7A</u>	<u>3C</u>	<u>8P</u>
King	<u>Power Equipment Operators</u>	Drill Oilers: Auger Type, Truck Or Crane Mount	\$57.72	<u>7A</u>	<u>3C</u>	<u>8P</u>
King	<u>Power Equipment Operators</u>	Drilling Machine	\$59.28	<u>7A</u>	<u>3C</u>	<u>8P</u>
King	<u>Power Equipment Operators</u>	Elevator And Man-lift: Permanent And Shaft Type	\$55.21	<u>7A</u>	<u>3C</u>	<u>8P</u>
King	<u>Power Equipment Operators</u>	Finishing Machine, Bidwell And Gamaco & Similar Equipment	\$58.17	<u>7A</u>	<u>3C</u>	<u>8P</u>
King	<u>Power Equipment Operators</u>	Forklift: 3000 Lbs And Over With Attachments	\$57.72	<u>7A</u>	<u>3C</u>	<u>8P</u>
King	<u>Power Equipment Operators</u>	Forklifts: Under 3000 Lbs. With Attachments	\$55.21	<u>7A</u>	<u>3C</u>	<u>8P</u>
King	<u>Power Equipment Operators</u>	Grade Engineer: Using Blue Prints, Cut Sheets, Etc	\$58.17	<u>7A</u>	<u>3C</u>	<u>8P</u>
King	<u>Power Equipment Operators</u>	Gradechecker/stakeman	\$55.21	<u>7A</u>	<u>3C</u>	<u>8P</u>
King	<u>Power Equipment Operators</u>	Guardrail Punch	\$58.17	<u>7A</u>	<u>3C</u>	<u>8P</u>
King	<u>Power Equipment Operators</u>	Hard Tail End Dump Articulating Off- Road Equipment 45 Yards. & Over	\$58.69	<u>7A</u>	<u>3C</u>	<u>8P</u>
King	<u>Power Equipment Operators</u>	Hard Tail End Dump Articulating Off-road Equipment Under 45 Yards	\$58.17	<u>7A</u>	<u>3C</u>	<u>8P</u>
King	<u>Power Equipment Operators</u>	Horizontal/directional Drill Locator	\$57.72	<u>7A</u>	<u>3C</u>	<u>8P</u>
King	<u>Power Equipment Operators</u>	Horizontal/directional Drill Operator	\$58.17	<u>7A</u>	<u>3C</u>	<u>8P</u>
King	<u>Power Equipment Operators</u>	Hydralifts/boom Trucks Over 10 Tons	\$57.72	<u>7A</u>	<u>3C</u>	<u>8P</u>
King	<u>Power Equipment Operators</u>	Hydralifts/boom Trucks, 10 Tons And Under	\$55.21	<u>7A</u>	<u>3C</u>	<u>8P</u>
King	<u>Power Equipment Operators</u>	Loader, Overhead 8 Yards. & Over	\$59.28	<u>7A</u>	<u>3C</u>	<u>8P</u>
King	<u>Power Equipment Operators</u>	Loader, Overhead, 6 Yards. But Not Including 8 Yards	\$58.69	<u>7A</u>	<u>3C</u>	<u>8P</u>
King	<u>Power Equipment Operators</u>	Loaders, Overhead Under 6 Yards	\$58.17	<u>7A</u>	<u>3C</u>	<u>8P</u>
King	<u>Power Equipment Operators</u>	Loaders, Plant Feed	\$58.17	<u>7A</u>	<u>3C</u>	<u>8P</u>
King	<u>Power Equipment Operators</u>	Loaders: Elevating Type Belt	\$57.72	<u>7A</u>	<u>3C</u>	<u>8P</u>
King	<u>Power Equipment Operators</u>	Locomotives, All	\$58.17	<u>7A</u>	<u>3C</u>	<u>8P</u>
King	<u>Power Equipment Operators</u>	Material Transfer Device	\$58.17	<u>7A</u>	<u>3C</u>	<u>8P</u>
King	<u>Power Equipment Operators</u>	Mechanics, All (leadmen - \$0.50 Per Hour Over Mechanic)	\$59.28	<u>7A</u>	<u>3C</u>	<u>8P</u>
King	<u>Power Equipment Operators</u>	Motor Patrol Graders	\$58.69	<u>7A</u>	<u>3C</u>	<u>8P</u>
King	<u>Power Equipment Operators</u>		\$58.69	<u>7A</u>	<u>3C</u>	<u>8P</u>

		Mucking Machine, Mole, Tunnel Drill, Boring, Road Header And/or Shield				
King	<u>Power Equipment Operators</u>	Oil Distributors, Blower Distribution & Mulch Seeding Operator	\$55.21	<u>7A</u>	<u>3C</u>	<u>8P</u>
King	<u>Power Equipment Operators</u>	Outside Hoists (elevators And Manlifts), Air Tuggers, strato	\$57.72	<u>7A</u>	<u>3C</u>	<u>8P</u>
King	<u>Power Equipment Operators</u>	Overhead, Bridge Type Crane: 20 Tons Through 44 Tons	\$58.17	<u>7A</u>	<u>3C</u>	<u>8P</u>
King	<u>Power Equipment Operators</u>	Overhead, Bridge Type: 100 Tons And Over	\$59.28	<u>7A</u>	<u>3C</u>	<u>8P</u>
King	<u>Power Equipment Operators</u>	Overhead, Bridge Type: 45 Tons Through 99 Tons	\$58.69	<u>7A</u>	<u>3C</u>	<u>8P</u>
King	<u>Power Equipment Operators</u>	Pavement Breaker	\$55.21	<u>7A</u>	<u>3C</u>	<u>8P</u>
King	<u>Power Equipment Operators</u>	Pile Driver (other Than Crane Mount)	\$58.17	<u>7A</u>	<u>3C</u>	<u>8P</u>
King	<u>Power Equipment Operators</u>	Plant Oiler - Asphalt, Crusher	\$57.72	<u>7A</u>	<u>3C</u>	<u>8P</u>
King	<u>Power Equipment Operators</u>	Posthole Digger, Mechanical	\$55.21	<u>7A</u>	<u>3C</u>	<u>8P</u>
King	<u>Power Equipment Operators</u>	Power Plant	\$55.21	<u>7A</u>	<u>3C</u>	<u>8P</u>
King	<u>Power Equipment Operators</u>	Pumps - Water	\$55.21	<u>7A</u>	<u>3C</u>	<u>8P</u>
King	<u>Power Equipment Operators</u>	Quad 9, Hd 41, D10 And Over	\$58.69	<u>7A</u>	<u>3C</u>	<u>8P</u>
King	<u>Power Equipment Operators</u>	Quick Tower - No Cab, Under 100 Feet In Height Based To Boom	\$55.21	<u>7A</u>	<u>3C</u>	<u>8P</u>
King	<u>Power Equipment Operators</u>	Remote Control Operator On Rubber Tired Earth Moving Equipment	\$58.69	<u>7A</u>	<u>3C</u>	<u>8P</u>
King	<u>Power Equipment Operators</u>	Rigger And Bellman	\$55.21	<u>7A</u>	<u>3C</u>	<u>8P</u>
King	<u>Power Equipment Operators</u>	Rigger/Signal Person, Bellman (Certified)	\$57.72	<u>7A</u>	<u>3C</u>	<u>8P</u>
King	<u>Power Equipment Operators</u>	Rollagon	\$58.69	<u>7A</u>	<u>3C</u>	<u>8P</u>
King	<u>Power Equipment Operators</u>	Roller, Other Than Plant Mix	\$55.21	<u>7A</u>	<u>3C</u>	<u>8P</u>
King	<u>Power Equipment Operators</u>	Roller, Plant Mix Or Multi-lift Materials	\$57.72	<u>7A</u>	<u>3C</u>	<u>8P</u>
King	<u>Power Equipment Operators</u>	Roto-mill, Roto-grinder	\$58.17	<u>7A</u>	<u>3C</u>	<u>8P</u>
King	<u>Power Equipment Operators</u>	Saws - Concrete	\$57.72	<u>7A</u>	<u>3C</u>	<u>8P</u>
King	<u>Power Equipment Operators</u>	Scraper, Self Propelled Under 45 Yards	\$58.17	<u>7A</u>	<u>3C</u>	<u>8P</u>
King	<u>Power Equipment Operators</u>	Scrapers - Concrete & Carry All	\$57.72	<u>7A</u>	<u>3C</u>	<u>8P</u>
King	<u>Power Equipment Operators</u>	Scrapers, Self-propelled: 45 Yards And Over	\$58.69	<u>7A</u>	<u>3C</u>	<u>8P</u>
King	<u>Power Equipment Operators</u>	Service Engineers - Equipment	\$57.72	<u>7A</u>	<u>3C</u>	<u>8P</u>
King	<u>Power Equipment Operators</u>	Shotcrete/gunite Equipment	\$55.21	<u>7A</u>	<u>3C</u>	<u>8P</u>
King	<u>Power Equipment Operators</u>	Shovel , Excavator, Backhoe, Tractors Under 15 Metric Tons.	\$57.72	<u>7A</u>	<u>3C</u>	<u>8P</u>
King	<u>Power Equipment Operators</u>		\$58.69	<u>7A</u>	<u>3C</u>	<u>8P</u>

		Shovel, Excavator, Backhoe: Over 30 Metric Tons To 50 Metric Tons				
King	<u>Power Equipment Operators</u>	Shovel, Excavator, Backhoes, Tractors: 15 To 30 Metric Tons	\$58.17	<u>7A</u>	<u>3C</u>	<u>8P</u>
King	<u>Power Equipment Operators</u>	Shovel, Excavator, Backhoes: Over 50 Metric Tons To 90 Metric Tons	\$59.28	<u>7A</u>	<u>3C</u>	<u>8P</u>
King	<u>Power Equipment Operators</u>	Shovel, Excavator, Backhoes: Over 90 Metric Tons	\$59.88	<u>7A</u>	<u>3C</u>	<u>8P</u>
King	<u>Power Equipment Operators</u>	Slipform Pavers	\$58.69	<u>7A</u>	<u>3C</u>	<u>8P</u>
King	<u>Power Equipment Operators</u>	Spreader, Topsider & Screedman	\$58.69	<u>7A</u>	<u>3C</u>	<u>8P</u>
King	<u>Power Equipment Operators</u>	Subgrader Trimmer	\$58.17	<u>7A</u>	<u>3C</u>	<u>8P</u>
King	<u>Power Equipment Operators</u>	Tower Bucket Elevators	\$57.72	<u>7A</u>	<u>3C</u>	<u>8P</u>
King	<u>Power Equipment Operators</u>	Tower Crane Up To 175' In Height Base To Boom	\$59.28	<u>7A</u>	<u>3C</u>	<u>8P</u>
King	<u>Power Equipment Operators</u>	Tower Crane: over 175' through 250' in height, base to boom	\$59.88	<u>7A</u>	<u>3C</u>	<u>8P</u>
King	<u>Power Equipment Operators</u>	Tower Cranes: over 250' in height from base to boom	\$60.47	<u>7A</u>	<u>3C</u>	<u>8P</u>
King	<u>Power Equipment Operators</u>	Transporters, All Track Or Truck Type	\$58.69	<u>7A</u>	<u>3C</u>	<u>8P</u>
King	<u>Power Equipment Operators</u>	Trenching Machines	\$57.72	<u>7A</u>	<u>3C</u>	<u>8P</u>
King	<u>Power Equipment Operators</u>	Truck Crane Oiler/driver - 100 Tons And Over	\$58.17	<u>7A</u>	<u>3C</u>	<u>8P</u>
King	<u>Power Equipment Operators</u>	Truck Crane Oiler/driver Under 100 Tons	\$57.72	<u>7A</u>	<u>3C</u>	<u>8P</u>
King	<u>Power Equipment Operators</u>	Truck Mount Portable Conveyor	\$58.17	<u>7A</u>	<u>3C</u>	<u>8P</u>
King	<u>Power Equipment Operators</u>	Welder	\$58.69	<u>7A</u>	<u>3C</u>	<u>8P</u>
King	<u>Power Equipment Operators</u>	Wheel Tractors, Farmall Type	\$55.21	<u>7A</u>	<u>3C</u>	<u>8P</u>
King	<u>Power Equipment Operators</u>	Yo Yo Pay Dozer	\$58.17	<u>7A</u>	<u>3C</u>	<u>8P</u>
King	<u>Power Equipment Operators- Underground Sewer & Water</u>	Asphalt Plant Operators	\$58.69	<u>7A</u>	<u>3C</u>	<u>8P</u>
King	<u>Power Equipment Operators- Underground Sewer & Water</u>	Assistant Engineer	\$55.21	<u>7A</u>	<u>3C</u>	<u>8P</u>
King	<u>Power Equipment Operators- Underground Sewer & Water</u>	Barrier Machine (zipper)	\$58.17	<u>7A</u>	<u>3C</u>	<u>8P</u>
King	<u>Power Equipment Operators- Underground Sewer & Water</u>	Batch Plant Operator, Concrete	\$58.17	<u>7A</u>	<u>3C</u>	<u>8P</u>
King	<u>Power Equipment Operators- Underground Sewer & Water</u>	Bobcat	\$55.21	<u>7A</u>	<u>3C</u>	<u>8P</u>
King	<u>Power Equipment Operators- Underground Sewer & Water</u>	Brokk - Remote Demolition Equipment	\$55.21	<u>7A</u>	<u>3C</u>	<u>8P</u>
King	<u>Power Equipment Operators- Underground Sewer & Water</u>	Brooms	\$55.21	<u>7A</u>	<u>3C</u>	<u>8P</u>
King	<u>Power Equipment Operators- Underground Sewer & Water</u>	Bump Cutter	\$58.17	<u>7A</u>	<u>3C</u>	<u>8P</u>

King	<u>Power Equipment Operators- Underground Sewer & Water</u>	Cableways	\$58.69	<u>7A</u>	<u>3C</u>	<u>8P</u>
King	<u>Power Equipment Operators- Underground Sewer & Water</u>	Chipper	\$58.17	<u>7A</u>	<u>3C</u>	<u>8P</u>
King	<u>Power Equipment Operators- Underground Sewer & Water</u>	Compressor	\$55.21	<u>7A</u>	<u>3C</u>	<u>8P</u>
King	<u>Power Equipment Operators- Underground Sewer & Water</u>	Concrete Pump: Truck Mount With Boom Attachment Over 42 M	\$58.69	<u>7A</u>	<u>3C</u>	<u>8P</u>
King	<u>Power Equipment Operators- Underground Sewer & Water</u>	Concrete Finish Machine -laser Screed	\$55.21	<u>7A</u>	<u>3C</u>	<u>8P</u>
King	<u>Power Equipment Operators- Underground Sewer & Water</u>	Concrete Pump - Mounted Or Trailer High Pressure Line Pump, Pump High Pressure.	\$57.72	<u>7A</u>	<u>3C</u>	<u>8P</u>
King	<u>Power Equipment Operators- Underground Sewer & Water</u>	Concrete Pump: Truck Mount With Boom Attachment Up To 42m	\$58.17	<u>7A</u>	<u>3C</u>	<u>8P</u>
King	<u>Power Equipment Operators- Underground Sewer & Water</u>	Conveyors	\$57.72	<u>7A</u>	<u>3C</u>	<u>8P</u>
King	<u>Power Equipment Operators- Underground Sewer & Water</u>	Cranes Friction: 200 tons and over	\$60.47	<u>7A</u>	<u>3C</u>	<u>8P</u>
King	<u>Power Equipment Operators- Underground Sewer & Water</u>	Cranes: 20 Tons Through 44 Tons With Attachments	\$58.17	<u>7A</u>	<u>3C</u>	<u>8P</u>
King	<u>Power Equipment Operators- Underground Sewer & Water</u>	Cranes: 100 Tons Through 199 Tons, Or 150' Of Boom (Including Jib With Attachments)	\$59.28	<u>7A</u>	<u>3C</u>	<u>8P</u>
King	<u>Power Equipment Operators- Underground Sewer & Water</u>	Cranes: 200 tons- 299 tons, or 250' of boom including jib with attachments	\$59.88	<u>7A</u>	<u>3C</u>	<u>8P</u>
King	<u>Power Equipment Operators- Underground Sewer & Water</u>	Cranes: 300 tons and over or 300' of boom including jib with attachments	\$60.47	<u>7A</u>	<u>3C</u>	<u>8P</u>
King	<u>Power Equipment Operators- Underground Sewer & Water</u>	Cranes: 45 Tons Through 99 Tons, Under 150' Of Boom (including Jib With Attachments)	\$58.69	<u>7A</u>	<u>3C</u>	<u>8P</u>
King	<u>Power Equipment Operators- Underground Sewer & Water</u>	Cranes: A-frame - 10 Tons And Under	\$55.21	<u>7A</u>	<u>3C</u>	<u>8P</u>
King	<u>Power Equipment Operators- Underground Sewer & Water</u>	Cranes: Friction cranes through 199 tons	\$59.88	<u>7A</u>	<u>3C</u>	<u>8P</u>
King	<u>Power Equipment Operators- Underground Sewer & Water</u>	Cranes: Through 19 Tons With Attachments A-frame Over 10 Tons	\$57.72	<u>7A</u>	<u>3C</u>	<u>8P</u>
King	<u>Power Equipment Operators- Underground Sewer & Water</u>	Crusher	\$58.17	<u>7A</u>	<u>3C</u>	<u>8P</u>
King	<u>Power Equipment Operators- Underground Sewer & Water</u>	Deck Engineer / deck Winches (power)	\$58.17	<u>7A</u>	<u>3C</u>	<u>8P</u>
King	<u>Power Equipment Operators- Underground Sewer & Water</u>	Derricks, On Building Work	\$58.69	<u>7A</u>	<u>3C</u>	<u>8P</u>
King	<u>Power Equipment Operators- Underground Sewer & Water</u>	Dozers D-9 & Under	\$57.72	<u>7A</u>	<u>3C</u>	<u>8P</u>

King	<u>Power Equipment Operators- Underground Sewer & Water</u>	Drill Oilers: Auger Type, Truck Or Crane Mount	\$57.72	<u>7A</u>	<u>3C</u>	<u>8P</u>
King	<u>Power Equipment Operators- Underground Sewer & Water</u>	Drilling Machine	\$59.28	<u>7A</u>	<u>3C</u>	<u>8P</u>
King	<u>Power Equipment Operators- Underground Sewer & Water</u>	Elevator And Man-lift: Permanent And Shaft Type	\$55.21	<u>7A</u>	<u>3C</u>	<u>8P</u>
King	<u>Power Equipment Operators- Underground Sewer & Water</u>	Finishing Machine, Bidwell And Gamaco & Similar Equipment	\$58.17	<u>7A</u>	<u>3C</u>	<u>8P</u>
King	<u>Power Equipment Operators- Underground Sewer & Water</u>	Forklift: 3000 Lbs And Over With Attachments	\$57.72	<u>7A</u>	<u>3C</u>	<u>8P</u>
King	<u>Power Equipment Operators- Underground Sewer & Water</u>	Forklifts: Under 3000 Lbs. With Attachments	\$55.21	<u>7A</u>	<u>3C</u>	<u>8P</u>
King	<u>Power Equipment Operators- Underground Sewer & Water</u>	Grade Engineer: Using Blue Prints, Cut Sheets, Etc	\$58.17	<u>7A</u>	<u>3C</u>	<u>8P</u>
King	<u>Power Equipment Operators- Underground Sewer & Water</u>	Gradechecker/stakeman	\$55.21	<u>7A</u>	<u>3C</u>	<u>8P</u>
King	<u>Power Equipment Operators- Underground Sewer & Water</u>	Guardrail Punch	\$58.17	<u>7A</u>	<u>3C</u>	<u>8P</u>
King	<u>Power Equipment Operators- Underground Sewer & Water</u>	Hard Tail End Dump Articulating Off- Road Equipment 45 Yards. & Over	\$58.69	<u>7A</u>	<u>3C</u>	<u>8P</u>
King	<u>Power Equipment Operators- Underground Sewer & Water</u>	Hard Tail End Dump Articulating Off-road Equipment Under 45 Yards	\$58.17	<u>7A</u>	<u>3C</u>	<u>8P</u>
King	<u>Power Equipment Operators- Underground Sewer & Water</u>	Horizontal/directional Drill Locator	\$57.72	<u>7A</u>	<u>3C</u>	<u>8P</u>
King	<u>Power Equipment Operators- Underground Sewer & Water</u>	Horizontal/directional Drill Operator	\$58.17	<u>7A</u>	<u>3C</u>	<u>8P</u>
King	<u>Power Equipment Operators- Underground Sewer & Water</u>	Hydralifts/boom Trucks Over 10 Tons	\$57.72	<u>7A</u>	<u>3C</u>	<u>8P</u>
King	<u>Power Equipment Operators- Underground Sewer & Water</u>	Hydralifts/boom Trucks, 10 Tons And Under	\$55.21	<u>7A</u>	<u>3C</u>	<u>8P</u>
King	<u>Power Equipment Operators- Underground Sewer & Water</u>	Loader, Overhead 8 Yards. & Over	\$59.28	<u>7A</u>	<u>3C</u>	<u>8P</u>
King	<u>Power Equipment Operators- Underground Sewer & Water</u>	Loader, Overhead, 6 Yards. But Not Including 8 Yards	\$58.69	<u>7A</u>	<u>3C</u>	<u>8P</u>
King	<u>Power Equipment Operators- Underground Sewer & Water</u>	Loaders, Overhead Under 6 Yards	\$58.17	<u>7A</u>	<u>3C</u>	<u>8P</u>
King	<u>Power Equipment Operators- Underground Sewer & Water</u>	Loaders, Plant Feed	\$58.17	<u>7A</u>	<u>3C</u>	<u>8P</u>
King	<u>Power Equipment Operators- Underground Sewer & Water</u>	Loaders: Elevating Type Belt	\$57.72	<u>7A</u>	<u>3C</u>	<u>8P</u>
King	<u>Power Equipment Operators- Underground Sewer & Water</u>	Locomotives, All	\$58.17	<u>7A</u>	<u>3C</u>	<u>8P</u>
King	<u>Power Equipment Operators- Underground Sewer & Water</u>	Material Transfer Device	\$58.17	<u>7A</u>	<u>3C</u>	<u>8P</u>
King	<u>Power Equipment Operators- Underground Sewer & Water</u>	Mechanics, All (leadmen - \$0.50 Per Hour Over Mechanic)	\$59.28	<u>7A</u>	<u>3C</u>	<u>8P</u>
King	<u>Power Equipment Operators- Underground Sewer & Water</u>	Motor Patrol Graders	\$58.69	<u>7A</u>	<u>3C</u>	<u>8P</u>

King	<u>Power Equipment Operators- Underground Sewer & Water</u>	Mucking Machine, Mole, Tunnel Drill, Boring, Road Header And/or Shield	\$58.69	<u>7A</u>	<u>3C</u>	<u>8P</u>
King	<u>Power Equipment Operators- Underground Sewer & Water</u>	Oil Distributors, Blower Distribution & Mulch Seeding Operator	\$55.21	<u>7A</u>	<u>3C</u>	<u>8P</u>
King	<u>Power Equipment Operators- Underground Sewer & Water</u>	Outside Hoists (elevators And Manlifts), Air Tuggers, strato	\$57.72	<u>7A</u>	<u>3C</u>	<u>8P</u>
King	<u>Power Equipment Operators- Underground Sewer & Water</u>	Overhead, Bridge Type Crane: 20 Tons Through 44 Tons	\$58.17	<u>7A</u>	<u>3C</u>	<u>8P</u>
King	<u>Power Equipment Operators- Underground Sewer & Water</u>	Overhead, Bridge Type: 100 Tons And Over	\$59.28	<u>7A</u>	<u>3C</u>	<u>8P</u>
King	<u>Power Equipment Operators- Underground Sewer & Water</u>	Overhead, Bridge Type: 45 Tons Through 99 Tons	\$58.69	<u>7A</u>	<u>3C</u>	<u>8P</u>
King	<u>Power Equipment Operators- Underground Sewer & Water</u>	Pavement Breaker	\$55.21	<u>7A</u>	<u>3C</u>	<u>8P</u>
King	<u>Power Equipment Operators- Underground Sewer & Water</u>	Pile Driver (other Than Crane Mount)	\$58.17	<u>7A</u>	<u>3C</u>	<u>8P</u>
King	<u>Power Equipment Operators- Underground Sewer & Water</u>	Plant Oiler - Asphalt, Crusher	\$57.72	<u>7A</u>	<u>3C</u>	<u>8P</u>
King	<u>Power Equipment Operators- Underground Sewer & Water</u>	Posthole Digger, Mechanical	\$55.21	<u>7A</u>	<u>3C</u>	<u>8P</u>
King	<u>Power Equipment Operators- Underground Sewer & Water</u>	Power Plant	\$55.21	<u>7A</u>	<u>3C</u>	<u>8P</u>
King	<u>Power Equipment Operators- Underground Sewer & Water</u>	Pumps - Water	\$55.21	<u>7A</u>	<u>3C</u>	<u>8P</u>
King	<u>Power Equipment Operators- Underground Sewer & Water</u>	Quad 9, Hd 41, D10 And Over	\$58.69	<u>7A</u>	<u>3C</u>	<u>8P</u>
King	<u>Power Equipment Operators- Underground Sewer & Water</u>	Quick Tower - No Cab, Under 100 Feet In Height Based To Boom	\$55.21	<u>7A</u>	<u>3C</u>	<u>8P</u>
King	<u>Power Equipment Operators- Underground Sewer & Water</u>	Remote Control Operator On Rubber Tired Earth Moving Equipment	\$58.69	<u>7A</u>	<u>3C</u>	<u>8P</u>
King	<u>Power Equipment Operators- Underground Sewer & Water</u>	Rigger And Bellman	\$55.21	<u>7A</u>	<u>3C</u>	<u>8P</u>
King	<u>Power Equipment Operators- Underground Sewer & Water</u>	Rigger/Signal Person, Bellman (Certified)	\$57.72	<u>7A</u>	<u>3C</u>	<u>8P</u>
King	<u>Power Equipment Operators- Underground Sewer & Water</u>	Rollagon	\$58.69	<u>7A</u>	<u>3C</u>	<u>8P</u>
King	<u>Power Equipment Operators- Underground Sewer & Water</u>	Roller, Other Than Plant Mix	\$55.21	<u>7A</u>	<u>3C</u>	<u>8P</u>
King	<u>Power Equipment Operators- Underground Sewer & Water</u>	Roller, Plant Mix Or Multi-lift Materials	\$57.72	<u>7A</u>	<u>3C</u>	<u>8P</u>
King	<u>Power Equipment Operators- Underground Sewer & Water</u>	Roto-mill, Roto-grinder	\$58.17	<u>7A</u>	<u>3C</u>	<u>8P</u>
King	<u>Power Equipment Operators- Underground Sewer & Water</u>	Saws - Concrete	\$57.72	<u>7A</u>	<u>3C</u>	<u>8P</u>
King	<u>Power Equipment Operators- Underground Sewer & Water</u>	Scraper, Self Propelled Under 45 Yards	\$58.17	<u>7A</u>	<u>3C</u>	<u>8P</u>
King			\$57.72	<u>7A</u>	<u>3C</u>	<u>8P</u>

	Power Equipment Operators- Underground Sewer & Water	Scrapers - Concrete & Carry All				
King	Power Equipment Operators- Underground Sewer & Water	Scrapers, Self-propelled: 45 Yards And Over	\$58.69	<u>7A</u>	<u>3C</u>	<u>8P</u>
King	Power Equipment Operators- Underground Sewer & Water	Service Engineers - Equipment	\$57.72	<u>7A</u>	<u>3C</u>	<u>8P</u>
King	Power Equipment Operators- Underground Sewer & Water	Shotcrete/gunite Equipment	\$55.21	<u>7A</u>	<u>3C</u>	<u>8P</u>
King	Power Equipment Operators- Underground Sewer & Water	Shovel , Excavator, Backhoe, Tractors Under 15 Metric Tons.	\$57.72	<u>7A</u>	<u>3C</u>	<u>8P</u>
King	Power Equipment Operators- Underground Sewer & Water	Shovel, Excavator, Backhoe: Over 30 Metric Tons To 50 Metric Tons	\$58.69	<u>7A</u>	<u>3C</u>	<u>8P</u>
King	Power Equipment Operators- Underground Sewer & Water	Shovel, Excavator, Backhoes, Tractors: 15 To 30 Metric Tons	\$58.17	<u>7A</u>	<u>3C</u>	<u>8P</u>
King	Power Equipment Operators- Underground Sewer & Water	Shovel, Excavator, Backhoes: Over 50 Metric Tons To 90 Metric Tons	\$59.28	<u>7A</u>	<u>3C</u>	<u>8P</u>
King	Power Equipment Operators- Underground Sewer & Water	Shovel, Excavator, Backhoes: Over 90 Metric Tons	\$59.88	<u>7A</u>	<u>3C</u>	<u>8P</u>
King	Power Equipment Operators- Underground Sewer & Water	Slipform Pavers	\$58.69	<u>7A</u>	<u>3C</u>	<u>8P</u>
King	Power Equipment Operators- Underground Sewer & Water	Spreader, Topsider & Screedman	\$58.69	<u>7A</u>	<u>3C</u>	<u>8P</u>
King	Power Equipment Operators- Underground Sewer & Water	Subgrader Trimmer	\$58.17	<u>7A</u>	<u>3C</u>	<u>8P</u>
King	Power Equipment Operators- Underground Sewer & Water	Tower Bucket Elevators	\$57.72	<u>7A</u>	<u>3C</u>	<u>8P</u>
King	Power Equipment Operators- Underground Sewer & Water	Tower Crane Up To 175' In Height Base To Boom	\$59.28	<u>7A</u>	<u>3C</u>	<u>8P</u>
King	Power Equipment Operators- Underground Sewer & Water	Tower Crane: over 175' through 250' in height, base to boom	\$59.88	<u>7A</u>	<u>3C</u>	<u>8P</u>
King	Power Equipment Operators- Underground Sewer & Water	Tower Cranes: over 250' in height from base to boom	\$60.47	<u>7A</u>	<u>3C</u>	<u>8P</u>
King	Power Equipment Operators- Underground Sewer & Water	Transporters, All Track Or Truck Type	\$58.69	<u>7A</u>	<u>3C</u>	<u>8P</u>
King	Power Equipment Operators- Underground Sewer & Water	Trenching Machines	\$57.72	<u>7A</u>	<u>3C</u>	<u>8P</u>
King	Power Equipment Operators- Underground Sewer & Water	Truck Crane Oiler /driver - 100 Tons And Over	\$58.17	<u>7A</u>	<u>3C</u>	<u>8P</u>
King	Power Equipment Operators- Underground Sewer & Water	Truck Crane Oiler /driver Under 100 Tons	\$57.72	<u>7A</u>	<u>3C</u>	<u>8P</u>
King	Power Equipment Operators- Underground Sewer & Water	Truck Mount Portable Conveyor	\$58.17	<u>7A</u>	<u>3C</u>	<u>8P</u>
King	Power Equipment Operators- Underground Sewer & Water	Welder	\$58.69	<u>7A</u>	<u>3C</u>	<u>8P</u>
King	Power Equipment Operators- Underground Sewer & Water	Wheel Tractors, Farmall Type	\$55.21	<u>7A</u>	<u>3C</u>	<u>8P</u>
King	Power Equipment Operators- Underground Sewer & Water	Yo Yo Pay Dozer	\$58.17	<u>7A</u>	<u>3C</u>	<u>8P</u>

King	<u>Power Line Clearance Tree Trimmers</u>	Journey Level In Charge	\$48.54	<u>5A</u>	<u>4A</u>	
King	<u>Power Line Clearance Tree Trimmers</u>	Spray Person	\$46.03	<u>5A</u>	<u>4A</u>	
King	<u>Power Line Clearance Tree Trimmers</u>	Tree Equipment Operator	\$48.54	<u>5A</u>	<u>4A</u>	
King	<u>Power Line Clearance Tree Trimmers</u>	Tree Trimmer	\$43.32	<u>5A</u>	<u>4A</u>	
King	<u>Power Line Clearance Tree Trimmers</u>	Tree Trimmer Groundperson	\$32.68	<u>5A</u>	<u>4A</u>	
King	<u>Refrigeration & Air Conditioning Mechanics</u>	Journey Level	\$75.36	<u>6Z</u>	<u>1G</u>	
King	<u>Residential Brick Mason</u>	Journey Level	\$54.32	<u>5A</u>	<u>1M</u>	
King	<u>Residential Carpenters</u>	Journey Level	\$28.20		<u>1</u>	
King	<u>Residential Cement Masons</u>	Journey Level	\$22.64		<u>1</u>	
King	<u>Residential Drywall Applicators</u>	Journey Level	\$41.69	<u>5D</u>	<u>4C</u>	
King	<u>Residential Drywall Tapers</u>	Journey Level	\$55.66	<u>5P</u>	<u>1E</u>	
King	<u>Residential Electricians</u>	Journey Level	\$30.44		<u>1</u>	
King	<u>Residential Glaziers</u>	Journey Level	\$39.40	<u>7L</u>	<u>1H</u>	
King	<u>Residential Insulation Applicators</u>	Journey Level	\$26.28		<u>1</u>	
King	<u>Residential Laborers</u>	Journey Level	\$23.03		<u>1</u>	
King	<u>Residential Marble Setters</u>	Journey Level	\$24.09		<u>1</u>	
King	<u>Residential Painters</u>	Journey Level	\$24.46		<u>1</u>	
King	<u>Residential Plumbers & Pipefitters</u>	Journey Level	\$34.69		<u>1</u>	
King	<u>Residential Refrigeration & Air Conditioning Mechanics</u>	Journey Level	\$75.36	<u>6Z</u>	<u>1G</u>	
King	<u>Residential Sheet Metal Workers</u>	Journey Level (Field or Shop)	\$45.99	<u>7F</u>	<u>1R</u>	
King	<u>Residential Soft Floor Layers</u>	Journey Level	\$45.86	<u>5A</u>	<u>3D</u>	
King	<u>Residential Sprinkler Fitters (Fire Protection)</u>	Journey Level	\$44.98	<u>5C</u>	<u>2R</u>	
King	<u>Residential Stone Masons</u>	Journey Level	\$54.32	<u>5A</u>	<u>1M</u>	
King	<u>Residential Terrazzo Workers</u>	Journey Level	\$50.26	<u>5A</u>	<u>1M</u>	
King	<u>Residential Terrazzo/Tile Finishers</u>	Journey Level	\$21.46		<u>1</u>	
King	<u>Residential Tile Setters</u>	Journey Level	\$25.17		<u>1</u>	
King	<u>Roofers</u>	Journey Level	\$47.51	<u>5A</u>	<u>3H</u>	
King	<u>Roofers</u>	Using Irritable Bituminous Materials	\$50.51	<u>5A</u>	<u>3H</u>	
King	<u>Sheet Metal Workers</u>	Journey Level (Field or Shop)	\$75.46	<u>7F</u>	<u>1E</u>	
King	<u>Shipbuilding & Ship Repair</u>	Boilermaker	\$41.72	<u>7M</u>	<u>1H</u>	
King	<u>Shipbuilding & Ship Repair</u>	Carpenter	\$41.06	<u>7T</u>	<u>2B</u>	
King	<u>Shipbuilding & Ship Repair</u>	Electrician	\$41.09	<u>7T</u>	<u>4B</u>	
King	<u>Shipbuilding & Ship Repair</u>	Heat & Frost Insulator	\$65.68	<u>5J</u>	<u>4H</u>	
King	<u>Shipbuilding & Ship Repair</u>	Laborer	\$41.08	<u>7T</u>	<u>4B</u>	

King	<u>Shipbuilding & Ship Repair</u>	Machinist	\$41.32	<u>7T</u>	<u>4B</u>	
King	<u>Shipbuilding & Ship Repair</u>	Operator	\$41.03	<u>7T</u>	<u>4B</u>	
King	<u>Shipbuilding & Ship Repair</u>	Painter	\$41.05	<u>7T</u>	<u>4B</u>	
King	<u>Shipbuilding & Ship Repair</u>	Pipefitter	\$41.05	<u>7T</u>	<u>4B</u>	
King	<u>Shipbuilding & Ship Repair</u>	Rigger	\$41.12	<u>7T</u>	<u>4B</u>	
King	<u>Shipbuilding & Ship Repair</u>	Sheet Metal	\$41.04	<u>7T</u>	<u>4B</u>	
King	<u>Shipbuilding & Ship Repair</u>	Shipfitter	\$41.12	<u>7T</u>	<u>4B</u>	
King	<u>Shipbuilding & Ship Repair</u>	Trucker	\$41.26	<u>7T</u>	<u>4B</u>	
King	<u>Shipbuilding & Ship Repair</u>	Warehouse	\$41.02	<u>7T</u>	<u>4B</u>	
King	<u>Shipbuilding & Ship Repair</u>	Welder/Burner	\$41.12	<u>7T</u>	<u>4B</u>	
King	<u>Sign Makers & Installers (Electrical)</u>	Sign Installer	\$22.92		<u>1</u>	
King	<u>Sign Makers & Installers (Electrical)</u>	Sign Maker	\$21.36		<u>1</u>	
King	<u>Sign Makers & Installers (Non-Electrical)</u>	Sign Installer	\$27.28		<u>1</u>	
King	<u>Sign Makers & Installers (Non-Electrical)</u>	Sign Maker	\$33.25		<u>1</u>	
King	<u>Soft Floor Layers</u>	Journey Level	\$45.86	<u>5A</u>	<u>3D</u>	
King	<u>Solar Controls For Windows</u>	Journey Level	\$12.44		<u>1</u>	
King	<u>Sprinkler Fitters (Fire Protection)</u>	Journey Level	\$72.89	<u>5C</u>	<u>1X</u>	
King	<u>Stage Rigging Mechanics (Non Structural)</u>	Journey Level	\$13.23		<u>1</u>	
King	<u>Stone Masons</u>	Journey Level	\$54.32	<u>5A</u>	<u>1M</u>	
King	<u>Street And Parking Lot Sweeper Workers</u>	Journey Level	\$19.09		<u>1</u>	
King	<u>Surveyors</u>	Assistant Construction Site Surveyor	\$57.72	<u>7A</u>	<u>3C</u>	<u>8P</u>
King	<u>Surveyors</u>	Chainman	\$57.17	<u>7A</u>	<u>3C</u>	<u>8P</u>
King	<u>Surveyors</u>	Construction Site Surveyor	\$58.69	<u>7A</u>	<u>3C</u>	<u>8P</u>
King	<u>Telecommunication Technicians</u>	Journey Level	\$22.76		<u>1</u>	
King	<u>Telephone Line Construction - Outside</u>	Cable Splicer	\$38.84	<u>5A</u>	<u>2B</u>	
King	<u>Telephone Line Construction - Outside</u>	Hole Digger/Ground Person	\$21.45	<u>5A</u>	<u>2B</u>	
King	<u>Telephone Line Construction - Outside</u>	Installer (Repairer)	\$37.21	<u>5A</u>	<u>2B</u>	
King	<u>Telephone Line Construction - Outside</u>	Special Aparatus Installer I	\$38.84	<u>5A</u>	<u>2B</u>	
King	<u>Telephone Line Construction - Outside</u>	Special Apparatus Installer II	\$38.03	<u>5A</u>	<u>2B</u>	
King	<u>Telephone Line Construction - Outside</u>	Telephone Equipment Operator (Heavy)	\$38.84	<u>5A</u>	<u>2B</u>	
King	<u>Telephone Line Construction - Outside</u>	Telephone Equipment Operator (Light)	\$36.09	<u>5A</u>	<u>2B</u>	
King	<u>Telephone Line Construction - Outside</u>	Telephone Lineperson	\$36.09	<u>5A</u>	<u>2B</u>	

King	<u>Telephone Line Construction - Outside</u>	Television Groundperson	\$20.33	<u>5A</u>	<u>2B</u>	
King	<u>Telephone Line Construction - Outside</u>	Television Lineperson/Installer	\$27.21	<u>5A</u>	<u>2B</u>	
King	<u>Telephone Line Construction - Outside</u>	Television System Technician	\$32.55	<u>5A</u>	<u>2B</u>	
King	<u>Telephone Line Construction - Outside</u>	Television Technician	\$29.18	<u>5A</u>	<u>2B</u>	
King	<u>Telephone Line Construction - Outside</u>	Tree Trimmer	\$36.09	<u>5A</u>	<u>2B</u>	
King	<u>Terrazzo Workers</u>	Journey Level	\$50.26	<u>5A</u>	<u>1M</u>	
King	<u>Tile Setters</u>	Journey Level	\$21.65		<u>1</u>	
King	<u>Tile, Marble & Terrazzo Finishers</u>	Finisher	\$41.09	<u>5A</u>	<u>1B</u>	
King	<u>Traffic Control Stripers</u>	Journey Level	\$44.85	<u>7A</u>	<u>1K</u>	
King	<u>Truck Drivers</u>	Asphalt Mix Over 16 Yards (W. WA-Joint Council 28)	\$52.70	<u>5D</u>	<u>3A</u>	<u>8L</u>
King	<u>Truck Drivers</u>	Asphalt Mix To 16 Yards (W. WA-Joint Council 28)	\$51.86	<u>5D</u>	<u>3A</u>	<u>8L</u>
King	<u>Truck Drivers</u>	Dump Truck & Trailer	\$52.70	<u>5D</u>	<u>3A</u>	<u>8L</u>
King	<u>Truck Drivers</u>	Dump Truck (W. WA-Joint Council 28)	\$51.86	<u>5D</u>	<u>3A</u>	<u>8L</u>
King	<u>Truck Drivers</u>	Other Trucks (W. WA-Joint Council 28)	\$52.70	<u>5D</u>	<u>3A</u>	<u>8L</u>
King	<u>Truck Drivers</u>	Transit Mixer	\$43.23		<u>1</u>	
King	<u>Well Drillers & Irrigation Pump Installers</u>	Irrigation Pump Installer	\$17.71		<u>1</u>	
King	<u>Well Drillers & Irrigation Pump Installers</u>	Oiler	\$12.97		<u>1</u>	
King	<u>Well Drillers & Irrigation Pump Installers</u>	Well Driller	\$18.00		<u>1</u>	



Attachment A, Version 2

(\$35,000 to \$150,000)

Invitation to Bid (by Fax)

The work described in the Invitation to Bid (by Fax) is subject to the following terms and conditions:

Bidder Responsibility: The bidder must meet the mandatory bidder responsibility criteria described below and as specified in RCW 39.04 or 2 CFR 200 in order to be considered a responsible contractor and be eligible for award consideration:

1. At the time of bid submittal, have a current certificate of registration in compliance with chapter 18.27 RCW, which must have been in effect at the time of the bid submittal;
2. Have a current Washington Unified Business Identifier (UBI) number;
3. If applicable:
 - Have Industrial Insurance (workers' compensation) coverage for the bidder's employees working in Washington, as required in Title 51 RCW;
 - Have a Washington Employment Security Department number, as required in Title 50 RCW;
 - Have a Washington Department of Revenue state excise tax registration number, as required in Title 82 RCW;
 - Electrical Contractor License, if required by Chapter 19.28 RCW
 - Elevator Contractor License, if required by Chapter 70.87 RCW
4. Not be disqualified from bidding on any public works contract under RCW 39.06.010 or RCW 39.12.065(3).
5. Has not more than one violation of the off-site, prefabricated, non-standard, project specific items reporting requirements of RCW 39.04.370. (Applicable until December 31, 2013)
6. Has not been debarred, suspended, or otherwise ineligible to contract with SHA and is not included on the Excluded Parties List System (EPLS) on GSA's SAM (System for Award Management) <https://www.sam.gov/portal/public/SAM/> or the Department of Housing and Urban Development's "Limited Denial of Participation" list. This requirement also applies to the Bidder's principals.

Prevailing Wages: The Contractor must pay all workers at least the prevailing wage rate for the type of work performed in accordance with the applicable prevailing wage rate schedule referenced on the Purchase Order or Request for Bid (by Fax) form and included in these solicitation documents. The type of wage schedule attached i.e., HUD Determined, Davis-Bacon, or the State Prevailing Wage schedule determines the appropriate labor standards that apply to the work as outlined below and contained in the General Conditions for Construction:

- 1) Part 11.13 for projects subject to the HUD-Determined wage rate schedule.
- 2) Part 11.12 for projects subject to Davis-Bacon wage schedule.
- 3) Part 5 for projects subject to the State prevailing wage schedule.

As part of its compliance with the prevailing wage requirements, the Contractor and, if applicable, subcontractor(s) shall comply with the requirement to submit a Statement of Intent to Pay Prevailing Wages and Affidavit of Wages Paid forms approved by the State of Washington's Department of Labor and Industries. The Owner will notify the Contractor of any special filing instructions that may apply for these forms depending on the funding source(s) of the project.

Bid Bond: SHA does not require a bid guarantee for small works roster construction projects estimated to cost \$150,000 or less.

Insurance: Within seven calendar days of award, the Contractor shall submit to SHA, and maintain throughout the contract, at no expense to SHA, the following insurance coverage at the limits noted (refer to Part 2 of SHA's General Conditions for more details):

1. Commercial General Liability Insurance. \$1,000,000 each occurrence, and \$2,000,000 aggregate
2. Additional Insured Endorsement Ongoing Operations: The Owner must be included as an Additional Insured on a primary and non-contributory basis on all Commercial General Liability policies of the Contractor. A policy endorsement form CG2010 or equivalent must be provided to Owner as evidence of additional insured coverage.
3. Additional Insured Endorsement Completed Operations: The Contractor's CGL insurance shall include the Owner as an additional insured for Contractors Completed Operations by providing additional insured status on the CG2037 endorsement, or by an equivalent policy or endorsement provision. The Contractors Completed Operations additional insured status for the Owner shall remain in effect for not less than three (3) years following the Final Acceptance of the Work by the Owner.
4. Employers Liability policy or Washington Stop Gap Liability insurance endorsement: \$1,000,000 each accident
5. Workers Compensation coverage.
6. Commercial Automobile Liability Insurance. \$1,000,000 combined single limit coverage
7. Pollution Liability Insurance: \$1,000,000 combined single limit coverage, if the work involves handling or disposal of asbestos, lead-based paint, contaminated soil, or other hazardous materials.

Performance & Payment Bond Requirements: Within seven calendar days of award, the Contractor shall submit to SHA, in accordance with Section 2.04 of the General Conditions, a Performance and Payment bond. Failure to furnish a Performance and Payment bond within the time specified may render the Contractor ineligible for the contract. The SHA may then either award the contract to the next lowest responsible bidder or solicit new bids.

Retainage Requirements: SHA requires retainage to be withheld for small works roster construction projects costing \$35,000 or more.

Tax Exempt Status of SHA: Pursuant to State law (RCW 35.82.210), SHA is exempt from paying sales tax when it obtains goods and services *directly* from the Contractor. The Contractor must pay sales tax on materials purchased for this job, and SHA will reimburse the Contractor for such taxes. ~~SHA does not pay sales tax for labor and services performed.~~

Protests: Any protest of award shall be resolved in accordance with SHA's Procurement Policies, which may be reviewed at the following web site address:
http://seattlehousing.org/business/guidelines/pdf/Procurement_Policies.pdf

General Conditions: SHA's General Conditions are hereby incorporated by reference and made a part of this Request for Bid (by Fax) and any subsequent contract or purchase order executed for this work as if fully included herein. If the event of any discrepancy between the terms of this Attachment A and the General Conditions, the terms of the General Conditions shall apply, except that the types and amounts of insurance specified above, and the waiver of the Contract Bond and withholding of retainage specified above, shall take precedence over the General Conditions. The General Conditions may be viewed by accessing the following Internet Web site address:
http://seattlehousing.org/business/guidelines/pdf/Construction_Contract_General_Conditions.pdf, or upon request, a copy of the General Conditions may be obtained by calling SHA at (206) 615-3379.

Performance Evaluation: The Contractor's performance on this project will be evaluated in accordance with SHA's Contractor Performance Evaluation Program. A copy of the Program may be obtained by accessing the following website:
http://seattlehousing.org/business/guidelines/pdf/Performance_Evaluation_Program.pdf.

Section 3: Section 3 of the Housing and Urban Development Act of 1968 (hereinafter "Section 3") requires SHA to the greatest extent feasible to provide employment opportunities to Section 3 residents. Section 3 residents include residents of SHA communities and other low-income residents of the metropolitan statistical area (MSA) covering King, Snohomish, and Pierce counties. Each bidder is required to submit with its Bid a Section 3 Resident Employment Plan that will result in hiring Section 3 residents to perform the

work contemplated by this solicitation, and a Section 3 Business Certification form. Failure to complete these forms may render a bid non-responsive.

A. Selection Preference for Section 3 Businesses: If a bidder claims to be a Section 3 business on the Section 3 Business Certification form required to be submitted with its Bid, and the Bid of the Section 3 business exceeds the low bid by no more than 10%, SHA will conduct an investigation whether the business qualifies as a Section 3 business, and SHA may award the contract to the Section 3 business at the price bid by the Section 3 business. In submitting a Bid, the bidder agrees to provide any information required by SHA to determine whether the business qualifies as a Section 3 business. A business may qualify as a Section 3 business by meeting one of the following criteria:

1. At least 51% of the business is owned by Section 3 qualified persons who live in the metropolitan statistical area (MSA) covering King, Snohomish, and Pierce counties and meet the prescribed income limitations based on family size as shown on the Section 3 Business Certification form.
2. 30% or more of the business' permanent, full-time employees (core employees within the last 12 months) are Section 3 qualified persons who live in the metropolitan statistical area (MSA) covering King, Snohomish, and Pierce counties and meet the prescribed income limitations based on family size as shown on the Section 3 Business Certification form.
3. The business makes a commitment to subcontract with Section 3 businesses for more than 25% of the dollar amount of all subcontracts to be awarded by the business. Prior to award, such businesses must submit a plan and the necessary support documents describing how the subcontracting commitment will be met. SHA will evaluate the plan and documents submitted and determine whether it is likely the bidder will attain the subcontracting percentage. SHA will monitor the Section 3 business' compliance with their subcontracting commitment. The bidder's failure to fulfill the Section 3 subcontracting commitment shall be a material breach of contract which may result in SHA taking any or all of the following actions: (1) demanding specific performance of the subcontracting plan; (2) withholding from contract payments the dollar amount of any or all subcontracts that were to have been awarded to Section 3 businesses or such lesser amount as may be appropriate; (3) withholding any liquidated damages that SHA may incur as a result of the bidder's failure to comply with its Section 3 commitment and subcontracting plan; and (4) declaring the bidder ineligible to compete for, or participate in, any SHA contract for a period of five years from the acceptance date of the contract in which the Section 3 subcontracting commitment was made.

B. Section 3 Contract Language: The following language regarding Section 3 will be included as part of the contract to be executed based on this solicitation.

1. The work to be performed under this contract is subject to the requirements of Section 3 of the Housing and Urban Development Act of 1968, as amended, 12 U.S.C. 1701u (Section 3). The purpose of Section 3 is to ensure that employment and other economic opportunities generated by HUD assistance or HUD-assisted projects covered by Section 3, shall, to the greatest extent feasible, be directed to low- and very low-income persons, particularly persons who are recipients of HUD assistance for housing.
2. The parties to this contract agree to comply with HUD's regulations in 24 CFR part 135, which implement Section 3. As evidenced by their execution of this contract, the parties to this contract certify that they are under no contractual or other impediment that would prevent them from complying with the part 135 regulations.
3. The contractor agrees to send to each labor organization or representative of workers with which the contractor has a collective bargaining agreement or other understanding, if any, a notice advising the labor organization or workers representative of the contractors commitments under this Section 3 clause, and will post copies of the notice in conspicuous places at the work site where both employees and applicants for training and employment positions can see the notice. The notice shall describe the Section 3 preference, shall set forth minimum number and job titles subject to hire, availability of apprenticeship and training positions, the qualifications for each; and the name and location of the person(s) taking applications for each of the positions; and the anticipated date the work shall begin.

4. The contractor agrees to include this Section 3 clause in every subcontract subject to compliance with regulations in 24 CFR part 135, and agrees to take appropriate action, as provided in an applicable provision of the subcontract in this Section 3 clause, upon a finding that the subcontractor is in violation of the regulations in 24 CFR part 135. The contractor will not subcontract with any subcontractor where the contractor has notice or knowledge that the subcontractor has been found in violation of the regulations in 24 CFR part 135.
5. The contractor will certify that any vacant employment positions, including training positions, that are filled (1) after the contractor is selected but before the contract is executed, and (2) with persons other than those to whom the regulations of 24 CFR part 135 require employment opportunities to be directed, were not filled to circumvent the contractors obligations under 24 CFR part 135.
6. Noncompliance with HUD's regulations in 24 CFR part 135 may result in sanctions, termination of this contract for default, and debarment or suspension from future HUD assisted contracts.
7. With respect to work performed in connection with Section 3-covered Indian Housing Assistance, Section 7(b) of the Indian Self-Determination and Education Assistance Act (25 U.S.C. 450e) also applies to the work to be performed under this Contract. Section 7(b) requires that to the greatest extent feasible (i) preference and opportunities for training and employment shall be given to Indians, and (ii) preference in the award of contracts and subcontracts shall be given to Indian organizations and Indian-owned Economic Enterprises. Parties to this Contract that are subject to the provisions of Section 3 and Section 7(b) agree to comply with Section 3 to the maximum extent feasible, but not in derogation of compliance with Section 7(b).
8. If the Contractor is a Section 3 business and was awarded the contract by SHA based on the Section 3 business preference requirements of the invitation to bid for committing to subcontract more than 25% of the dollar amount of all subcontracts to Section 3 businesses, the Contractor agrees to meet the Section 3 subcontracting commitment. Failure of the Contractor to fulfill the Section 3 subcontracting commitment shall be deemed a material breach of contract, which may result in SHA taking any or all of the following actions: (1) demanding specific performance of the subcontracting plan; (2) withholding from contract payments the dollar amount of any or all subcontracts that were to have been awarded to Section 3 businesses or such lesser amount as may be appropriate, (3) withholding any liquidated damages that SHA may incur as a result of the Contractor's failure to comply with its Section 3 commitment and subcontracting plan; and (4) declaring the Contractor ineligible to compete for, or participate in, any SHA contract for a period of five years from the acceptance date of the contract in which the Section 3 subcontracting commitment was made.

Seattle Housing Authority

Section 3 Business Certification

The work to be performed under this contract is subject to the requirements of Section 3 of the Housing and Urban Development Act of 1968, as amended, 12 U.S.C. 1701u (Section 3). The purpose of Section 3 is to ensure that employment and other economic opportunities generated by HUD assistance or HUD-assisted projects covered by Section 3, shall, to the greatest extent feasible, be directed low-and very low-income persons, particularly persons who are recipients of HUD assistance for housing.

Section 3 Business Criteria: Your business is eligible for Section 3 Certification if it meets any one of the following criteria. If your business meets one or more of these criteria, please circle the applicable criteria.

1. Fifty-one percent or more of your business is owned and managed by a Section 3 qualified person or persons. (See qualification guidelines below) A completed and signed Individual Certification form for each Section 3 qualified person or persons is required to be submitted.
2. Thirty percent or more of your permanent, full time employees are Section 3 qualified persons. (When seeking certification under this criteria, please submit a listing of all current, permanent, full-time employees, as well as a completed and signed Individual Certification form for each Section 3 qualified employee.)
3. You can provide evidence of a commitment to subcontract in excess of 25 percent of the amount of all subcontracts to Section 3 certified businesses. (When seeking certification under these criteria, please consult with the Section 3 Coordinator regarding the documentation to be submitted.)

Section 3 Person Criteria: A Section 3 qualified person must:

- 1) Be a City of Seattle Housing Authority public housing resident; or
- 2) Live in the metropolitan statistical area (MSA) covering King, Snohomish, and Pierce counties, and,
- 3) Earn no more than the following amounts for the respective MSA area:

Region/Area	1 Person	2 Persons	3 Persons	4 Persons	5 Persons	6 Persons	7 Persons	8 Persons
King and Snohomish Counties	\$ 48,550	\$55,450	\$ 62,400	\$ 69,300	\$ 74,850	\$ 80,400	\$ 85,950	\$ 91,500
Pierce County	\$ 40,500	\$ 46,300	\$ 52,100	\$ 57,850	\$ 62,500	\$ 67,150	\$71,750	\$ 76,400

Section 3 Statement: Please check the appropriate box below.

- ☐ My business is eligible to be certified as a Section 3 business in accordance with the criteria circled above under Section 3 Business Criteria.
- ☐ My business is not a Section 3 business.

Signature:		Date Signed:
Name:	Title:	
Company Name:		
Address:		
Telephone Number:		

Note: If you certify above that your business is a Section 3 business, SHA will request documentation and additional information as may be reasonably required to certify whether your business qualifies as a Section 3 business.

Section 3 Resident Employment Plan

Section 3 of the Housing and Urban Development Act of 1968 (hereinafter "Section 3") requires SHA, to the greatest extent feasible, to provide employment opportunities to "Section 3 residents." Section 3 residents include residents of SHA communities and other low income residents of the metropolitan statistical area (hereinafter "MSA") covering King, Snohomish, and Pierce counties. SHA residents, preferably residents of the SHA community in which the work is to be done, are favored over other low-income residents of the MSA.

For construction contracts only:

- Each bidder is required to submit with their bid package a plan which will result in the hiring of Section 3 residents to perform the work contemplated by the bid. SHA has established a goal that 100% of all new hires be Section 3 Residents to the greatest extent feasible.
- At a minimum, the Contractor and its subcontractors shall advertise new positions created in order to perform the work called for herein and will post notices to the Contractor's commitments under Section 3 in conspicuous places at the work site. In addition, the Contractor must notify each labor organization with whom it or its subcontractors have a collective bargaining agreement or other understanding of these Section 3 commitments.

In order to fulfill its Section 3 obligations, the Contractor may work with service providers on site at various SHA communities including, but not limited to, Neighborhood House and the Employment Opportunities Center. The plan should specify the number of positions the Contractor expects will be created and what minimum qualifications and skills will be required in order to perform the positions. The plan, if applicable, should also address the Contractor strategy for recruiting SHA residents for the available positions, which should include consultation with SHA's Section 3 Coordinator.

1. How many new positions do you expect this contract will require you to create?

2. Describe each position and provide the name and provide the location of the person(s) taking applications for each such position.

3. What minimum skills will be required for each position?

4. Please describe any training opportunities which the contract may create and any agreements concerning training you have.

5. How will you advertise these positions to SHA residents?

If you have any questions about this form, please call Samuel Pierce, SHA's Section 3 Coordinator, at (206) 913-9227.

SEATTLE HOUSING AUTHORITY

SUSPENSION AND DEBARMENT COMPLIANCE CERTIFICATE FOR CONTRACTOR

By signing below, the Contractor certifies that to the best of its knowledge and belief neither its firm nor any of its principals as named below are presently debarred, suspended, or have been declared ineligible or are excluded from participation in this transaction by any federal, state or local government.

Contractor's Firm Name: _____

Address: _____

City, State, Zip: _____

	PRINCIPAL(S) Name(s)	Title(s)
1		
2		
3		
4		
5		

Contractor's Signature	Printed Name	Title	Date

NOTE: This requirement applies to the Contractor's firm as well as its principals. Principal is defined in the regulation (2 CFR 180.995) as follows:

- 1) An officer, director, owner, partner, principal investigator, or other person within a participant with management or supervisory responsibilities related to a covered transaction; or
- 2) A contractor or other person, whether or not employed by the participant or paid with Federal funds, who-
 - a) Is in a position to handle Federal funds;
 - b) Is in a position to influence or control the use of those funds; or,
 - c) Occupies a technical or professional position capable of substantially influencing the development or outcome of an activity require to perform the covered transaction.

The federal websites to verify eligibility include: <https://www.sam.gov/portal/public/SAM/> and [http://portal.hud.gov/hudportal/HUD?src=/topics/limited denials of participation](http://portal.hud.gov/hudportal/HUD?src=/topics/limited%20denials%20of%20participation).

SEATTLE HOUSING AUTHORITY

SUSPENSION AND DEBARMENT COMPLIANCE CERTIFICATE FOR SUB-CONTRACTORS

The Prime Contractor may use this form if the Prime can verify that their Sub-Contractors named below, nor any of their principals are debarred, suspended or ineligible from involvement by Federal, State or Local Government. If the Prime is unable to verify this information, the Prime must send the previous SUSPENSION AND DEBARMENT COMPLIANCE CERTIFICATE FOR CONTRACTOR form to each sub- contractor to be completed and returned.

Prime Contractor's Name: _____ certifies that neither any of the sub- contracting firms named below, nor any of its principals are debarred, suspended or ineligible from involvement by Federal, State or Local Government. I understand that the Seattle Housing Authority (SHA) relies on this certification and I understand that I am obligated to submit the following to SHA:

- A certification for any new sub- contractor hired after submission of this certification.
- A renewal certification for every sub- contractor on the anniversary of the Contract execution date if the Contract Time extends beyond one year.

(Note: In lieu of this certification, the Prime Contractor may elect to submit a separate certification signed by each sub- contracting firm to SHA as evidence of sub- contractor eligibility. It is the Prime Contractor's responsibility to initiate, obtain, and provide all such individual sub- contractor certifications to SHA.)

Prime Contractor's Signature	Printed Name	Title	Date

Sub- Contractor Firm Listing: (If sub- contractors are not involved in the project, please enter NONE.)

If additional pages are necessary, copy this form to ensure signed statement precedes any listing of sub- contractors.

Please contact Al Hoffer at 206-615-3381 or by e-mail at Al.Hoffer@seattlehousing.org if you have any questions regarding compliance with this requirement.



VENDOR FACT SHEET

Return this Form TO: Seattle Housing Authority, Purchasing Division,
ATTN: _____
190 Queen Anne Ave N, P.O Box 19028, Seattle WA 98109-1028

General Business Information:

Name of Business, Organization, or Name of Person (if payment is to an individual):

For SHA Use Only:

JDE Vendor No.

Mailing Address for Payments:

City:

State:

Zip Code:

E-Mail Address:

Telephone No.:

Fax No.:

DUNS No.:

Washington UBI No.:

City of Seattle Business License No.:

Washington Contractor's License No.:

President/General Manager:

Principal products and/or services offered:

Type of Organization (check one):

Individual

☐

Sole Proprietor

☐

Partnership

☐

Corporation

☐

Governmental Agency

☐

Other

☐

Employee Tax ID No. (TIN) or Social Security No. (if Individual):

Substitute IRS Form W-9 Certification:

Under penalties of perjury, I hereby certify that the number shown on this form is my correct taxpayer identification number, and that I am not subject to backup withholding because: (a) I am exempt from backup withholding, or (b) I have not been notified by the Internal Revenue Service (IRS) that I am subject to backup withholding as a result of a failure to report all interest or dividends, or (c) the IRS has notified me that I am no longer subject to backup withholding, and I am a U.S. person (including a U.S. resident alien). **Note:** The Internal Revenue Service does not require your consent to any provision of this document other than the certifications required to avoid backup withholding.

**SIGN
HERE →**

Signature of U.S. Person

Date

Ownership Status (check all that apply):

- ☐ **MBE** (Minority-Owned Business Enterprise)
☐ **WBE** (Women-Owned Business Enterprise)
☐ **MWBE** (Minority / Women-Owned Business Enterprise)
☐ **CBE** (Combination Business Enterprise)
☐ **Small Business** ☐ **HUD Section 3 Business**

☐ Certified by OMWBE (Washington State Office of Minority and Women's Business Enterprises)

☐ Self-Identified (SHA may request a signed statement re: self-certification)

Racial/Ethnic Status (check one):

- ☐ Caucasian (1)
☐ African American (2)
☐ Native American (3)
☐ Hispanic American (4)
☐ Asian/Pacific American (5)
☐ Hasidic Jews (6)

Method of Contract Payments: As outlined on the reverse side of this form, for contracts over one million dollars, SHA's method of contract payments is through an electronic virtual credit card issued by SHA's e-payables vendor, Bank of America. Unless SHA grants a waiver, Vendors will receive an enrollment form from SHA following issuance of a contract.

SIGN BELOW:

Signature of Authorized Representative of Vendor:

Date:

By signing immediately above, the Vendor hereby represents the following:

- a) The Vendor certifies that to the best of its knowledge and belief, neither it, nor any person/principal or firm which has an interest in the Vendor's firm, is ineligible to participate in a SHA contract, purchase order, direct pay or other transaction, pursuant to the Certification of Eligibility provision specified in the Vendor Fact Sheet Instructions, or;
- b) The Vendor will comply with SHA's General Terms and Conditions applicable to Purchase Orders, if the Vendor will be supplying goods and/or services through an SHA Purchase Order.

To obtain a copy of the General Terms and Conditions, call (206) 615-3379 or visit our Web site at http://seattlehousing.org/business/guidelines/pdf/Purchase_Order_Terms_Conditions.pdf.

Vendor Fact Sheet Instructions

Thank you for your interest in doing business with the Seattle Housing Authority (SHA). We look forward to doing business with you. If you have any questions about completion of the Vendor Fact Sheet, please call us at (206) 615-3379.

In order for SHA to make payments to you or to procure goods or services from you, we need the information requested on the Vendor Fact Sheet, which also serves as a substitute IRS W-9 Form. The information about you will be entered into our computerized payment system and will allow us to make required reports to the Federal government about our business and payment transactions.

Substitute IRS Form W-9 Certification: In completing the Vendor Fact Sheet, you must sign the "Substitute IRS Form W-9 Certification" or backup withholding will apply. If you are subject to backup withholding and you are merely providing your correct taxpayer identification number to SHA, you must cross out the portion of the certification after the word "and" in line two, through the end of line five, before signing the form. Detailed instructions about IRS Form W-9 are included on the form, which may be obtained by calling our office at (206) 615-3379 or visiting the IRS web site at www.irs.gov.

Certification of Eligibility: In order to do business with SHA, the Vendor must be eligible to:

- 1) Be awarded contracts by any agency of the U.S. Government, HUD, or the State in which this Contract work is to be performed; or,
- 2) Participate in HUD programs pursuant to 24 CFR Part 24.

The websites to verify eligibility of the firm and its principals are: <https://www.sam.gov/portal/public/SAM/> and http://portal.hud.gov/hudportal/HUD?src=/topics/limited_denials_of_participation. By signing the Vendor Fact Sheet, the Vendor understands that the certification of eligibility is a material representation of fact upon which reliance was placed when SHA agreed to enter into the transaction with the Vendor. SHA may require the Vendor to submit such certification on an annual basis depending on the terms of its contract or the frequency of its business transactions with SHA. If the Vendor subcontracts any portion of the work, the Vendor will be required to submit a similar certification of eligibility to SHA for any Vendor subcontracts. Any written contract executed between SHA and the Vendor shall include these provisions, which may also be referred to as Suspension/Debarment provisions.

Contract Payments: Unless SHA grants a waiver, its method of contract payment for contracts of one million or more is through its Bank of America epayables program. Payments will be made electronically through a virtual Visa credit card. Benefits for using this method include reduced labor costs associated with the processing of checks and enhancing cash flow by eliminating float time associated with the mailing of checks. To learn more about the program, please click here or copy and paste the following URL into your browser: www.bankofamerica.com/epayablesvendors. For new vendors, SHA will automatically send an enrollment form upon contract award. If you have questions about the program, please contact Brenda Mix, SHA's Accounts Payable Manager, at 206-615-3421 or bmix@seattlehousing.org.

Small Businesses: The Vendor Fact Sheet also requests information about whether your business is owned and controlled by women or minorities, and/or is a small business. The following are definitions of these terms for your use. This information provides valuable information to SHA in its efforts to ensure its contracting program meets its diversity objectives and requirements.

- **WMBE:** Minority and women-owned business enterprises must either be self-identified or certified by the Washington State Office of Women's and Minority Business Enterprises (OMWBE) to be at least fifty-one percent owned by women and/or minority group members.
- **Small Business:** A small business means a business concern, including its affiliates, that is independently owned and operated, not an affiliate or subsidiary of a business dominant in its field of operation, and qualified as a small business under the criteria and size standards in 13 CFR 121. Furthermore, a business is considered small according to the Small Business Administration's established guidelines provided to such businesses.
- **HUD Section 3 Business:** A business that is owned 51% or more by a Section 3 qualified person, or where 30% or more of the permanent, full-time employees of the business are Section 3 qualified persons, or where the business can provide evidence of a commitment to subcontract in excess of 25% of the amount of all subcontracts to other Section 3 certified businesses. A Section 3 qualified person must live in the metropolitan statistical areas identified on SHA's Section 3 form and whose income level meets or falls below the stated income limits.

Seattle Housing Authority Contract Insurance Requirements

Fill in your insurance agent's name & either their FAX # or e-mail address & send this Contract Insurance Requirements form to them. (The information on this form tells your agent what insurance documentation to send to the Seattle Housing Authority.)

Insurance Agent's Name:			FAX Number OR E-Mail Address:		
Contract No.	5013	Project Name:	Rainier Vista Phase 1 Roof and Gutter Cleaning		
Name :					
Estimated Contract Amount Between:			\$45,000	and	\$55,000
Estimated Project Start Date:		8/19/2017	Estimated Project End Date:		11/19/2017
Brief Scope of Work: Cleaning of roof and gutter systems and gutter repair if needed.					

Insurance Documentation: The Seattle Housing Authority needs the following evidence of insurance for the contractor/consultant and contract noted above before they can begin work on this contract. Please submit the following (only for those checked):

- ☐ An ACORD Certificate of Insurance.
- ☐ Commercial General Liability: \$1,000,000 (or \$) each occurrence, \$2,000,000 (or \$) aggregate *(relates to Consultant Contracts only)*
- ☒ Commercial General Liability: \$1,000,000 (or \$) each occurrence, \$2,000,000 (or \$) Per Project aggregate *(relates to Construction Contracts only)*
- ☒ Additional Insured Endorsement Ongoing Operations naming the Seattle Housing Authority and Escallonia LP as an additional insured on a primary and non-contributory basis on the Commercial General Liability policy, ISO form CG2010 or equivalent. Blanket additional insured endorsements may be acceptable, but must be approved by SHA's Risk Manager.
- ☐ Additional Insured Endorsement Completed Operations ISO Form CG2037 or equivalent. Blanket additional insured endorsements may be acceptable, but must be approved by SHA's Risk Manager
- ☐ Washington Stop Gap or Employers Liability: \$1,000,000 (or \$) each occurrence
- ☒ Workers Compensation
- ☒ Automobile Liability: \$1,000,000 (or \$) combined single limit
- ☐ Professional Liability/Errors & Omissions: \$1,000,000 (or \$) per claim/aggregate
- ☐ Crime Fidelity, Theft, Disappearance & Destruction Liability (to include Employee Dishonesty): \$1,000,000 per claim/aggregate
- ☐ Cyber Liability including coverage for Business Interruption, Network Security, and Electronic Communication: \$1,000,000 per claim / aggregate
- ☐ Pollution Liability: \$1,000,000 (or \$) each occurrence, \$1,000,000 (or \$) aggregate
- ☒ Evidence that sexual misconduct has not been excluded from the commercial general liability policy

Other Requirements: The Certificate of Insurance should note that at least 45 days advance notice of cancellation for any reason and 10 day for non-payment of premium must be provided to the Seattle Housing Authority. Insurance companies must have a Best's rating of "A VII" or better; all others must be approved by SHA's Risk Management department.

Questions: If you have any questions about these insurance requirements, please call **Erica Snyder** at the Seattle Housing Authority at (206) 615-3541

☛ **Please send the insurance documentation ASAP, to:**
 Alan Hoffer, Sr. Contract Administrator
 Seattle Housing Authority, Purchasing Division
 P.O. Box 19028, Seattle, WA 98109-1028
 or FAX to: (206) 615-3410 or e-mail to: Al.Hoffer@seattlehousing.org



Address 190 Queen Anne Ave N
PO Box 19028
Seattle, WA 98109
Telephone 206-615-3300
TTY 1-800-833-6388
Website www.seattlehousing.org

Certification of Compliance with Wage Payment Statutes

The undersigned hereby certifies that the bidder is now, and in the three-year period immediately preceding the date of this bid solicitation (INSERT DATE) has been, in compliance with the responsible bidder criteria requirement of RCW 39.04.350(1)(g) and has not been found to have willfully violated any provision of RCW Chapters 49.46, 49.48, or 49.52 in a final determination by the Department of Labor and Industries or any court of limited or general jurisdiction.

I certify under penalty of perjury under the laws of the State of Washington that the foregoing is true and correct.

Bidder's Business Name

Signature of Authorized Official*

Printed Name

Title

Date

City

State

Check One:

Sole Proprietorship ☐ Partnership ☐ Joint Venture ☐ Corporation ☐

State of Incorporation, or if not a corporation, State where business entity was formed:

If a co-partnership, give firm name under which business is transacted:

If a corporation, proposal must be executed in the corporate name by the president or vice-president (or any other corporate officer accompanied by evidence of authority to sign). If a co-partnership, proposal must be executed by a partner.